

MASTER PLAN HOPETON LANDING

SAVANNAH, GA

- 1 INSTITUTIONAL / OFFICE - 5.8 AC
 - 2 INSTITUTIONAL / OFFICE - 5.4 AC
 - 3 INSTITUTIONAL / OFFICE - 14.0 AC
 - 4 COMMERCIAL - 10.5 AC
 - 5 TOWN HOMES RESIDENTIAL - 17.5 AC, 8 UNITS PER AC
 - 6 MULTI-FAMILY RESIDENTIAL - 35.5 AC, 12 UNITS PER AC
 - 7 SINGLE FAMILY RESIDENTIAL - 28.8 AC, 4 UNITS PER AC
 - 8 SINGLE FAMILY RESIDENTIAL - 20.7 AC, 4 UNITS PER AC
 - 9 SINGLE FAMILY RESIDENTIAL - 33.8 AC, 4 UNITS PER AC
 - 10 FUTURE DEVELOPMENT - 98.3
- WETLAND - SALT MARSH - (37.5 AC)
 - WETLAND - FRESHWATER - (147.5 AC)
 - AMENITY AREA AND PARK - (2.3 AC)
 - GREENSPACE AND SPINE ROAD ROW - (10.3 AC)
 - TRAILS

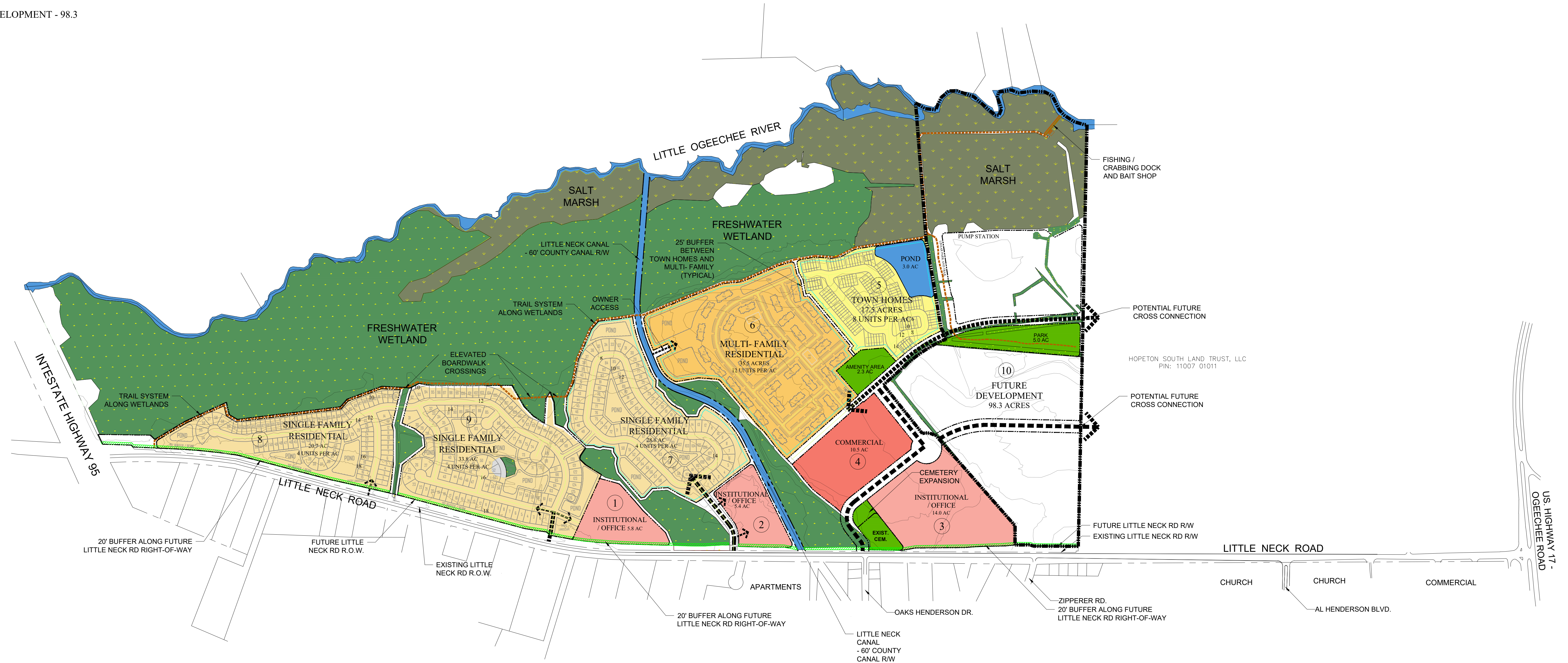

SUMMARY

LAND USE	AREA (acres)	UNITS
INSTITUTIONAL/ OFFICE COMMERCIAL	35.7	
FUTURE DEVELOPMENT	98.3	
MULTI-FAMILY RESIDENTIAL	64.3	594
SINGLE FAMILY RESIDENTIAL	54.5	332
TOWNHOMES	17.5	140
AMENITY AREA AND PARK	2.3	
WETLAND - SALT MARSH	37.5	
WETLAND - FRESHWATER	147.9	
GREEN SPACE and SPINE ROAD ROW	10.3	
EX CEMETERY & EXPANSION	2.0	
R.O.W. DEDICATION	7.7	
TOTAL	478.0	1,066

NOTES

- TOTAL UNITS BASED ON APPROXIMATE ACREAGE AND MAY VARY BASED ON SURVEY.
- ACREAGES ARE APPROXIMATE AND NOT BASED ON A SURVEY. ACREAGE MAY VARY BASED ON SURVEY.
- STORMWATER DETENTION IS REQUIRED FOR EACH DEVELOPMENT POD AS PER REGULATIONS.
- WETLANDS MAY REQUIRE BUFFERS AS PER REGULATIONS.
- AREAS UNDER POWER LINES MAY BE USED FOR PARKING, OPEN SPACE AND SOME STORM WATER DETENTION.
- PASSIVE AND ACTIVE RECREATION AREAS TO BE INCLUDED WITH INDIVIDUAL SUBDIVISION AND MULTI-FAMILY RESIDENTIAL DEVELOPMENTS.
- BUFFERS: TO BE IN ACCORDANCE WITH ARTICLE 9.5 OF THE CITY OF SAVANNAH ZONING ORDINANCE. BUFFERS MAY BE UNDISTURBED OR PLANTED.
- TREE PRESERVATION (TREE QUALITY AND LANDSCAPE QUALITY POINT REQUIREMENTS) TO BE MET WITH PRESERVED WETLAND AREAS, AND SUPPLEMENTAL PLANTINGS AS NEEDED.

NOTE: For PD zoning, all land uses are accounted for in the Summary Table including the power line easement and lands below 6 ft. elevation.

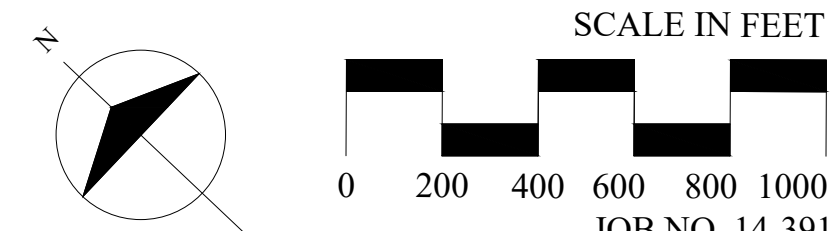

JOB NO. 14-391
MAY 25, 2021