

**General Notes**  
 THIS DRAWING AND ALL INSTRUMENTS  
 HEREON, INCLUDING ANY INSTRUMENTS  
 OF SERVICE, IS AND SHALL REMAIN  
 THE PROPERTY OF ECO FRIENDLY  
 CONSTRUCTION & DESIGN, INC. IT IS  
 CONTRACTING AND DESIGN ONLY. IT  
 REPRODUCTION, EITHER WHOLE OR  
 PARTIAL, IS PROHIBITED WITHOUT THE  
 WRITTEN CONSENT.



1600 Staley Avenue  
 Savannah, GA 31405  
 Office : (912) 344-4229  
 ec@savannah.com

SCALE: NOT VALID UNLESS DISCUSSED

No.	Revision/Issue	Date

**PROPOSED  
 SITE PLAN**

Project Name and Address  
 1600 Staley Ave  
 Savannah, Ga. 31405

Drawn JL	Sheet P-01
Date 04/18/2023	Scale 1/4" = 1'-0"

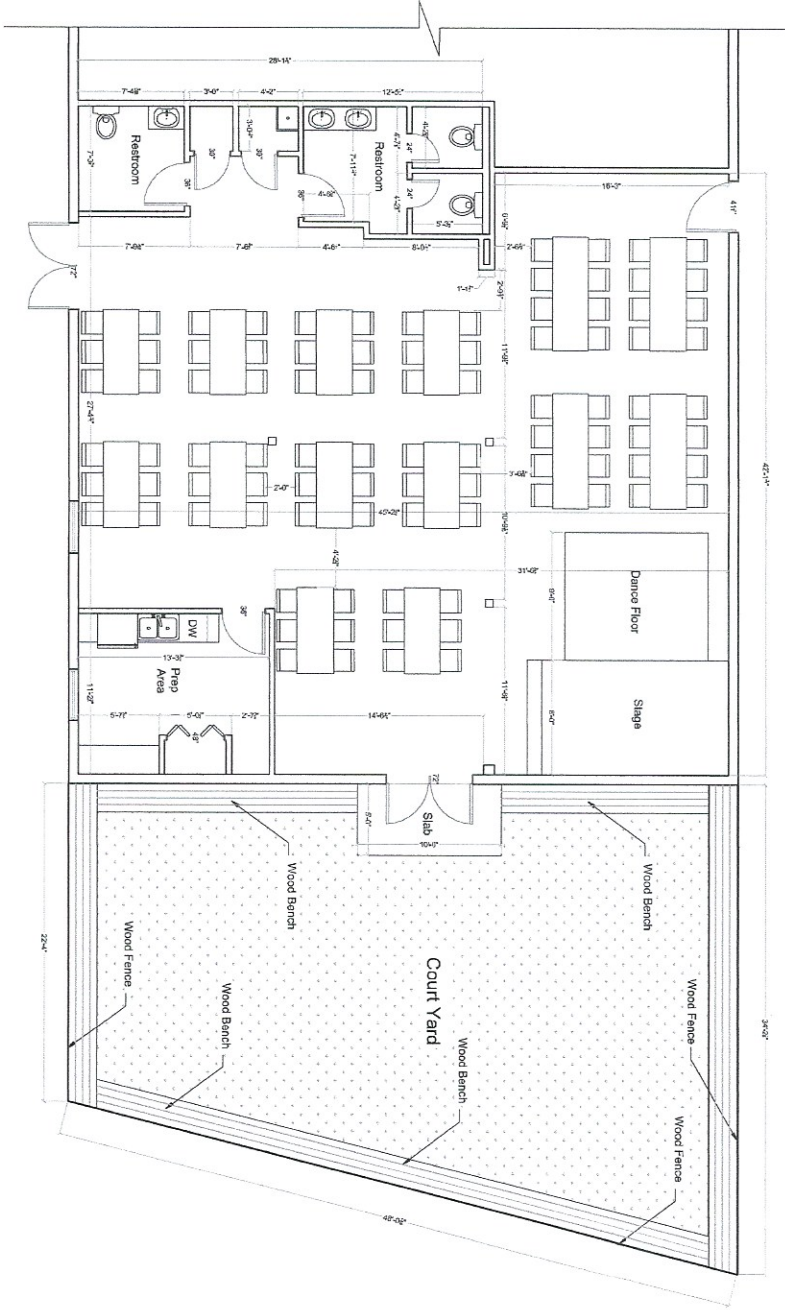

PROPOSED FLOOR PLAN  
SCALE 1/4" = 1'-0"

**General Notes**

THIS DRAWING AND ALL VERTICAL DIMENSIONS ARE THE PROPERTY OF ECO FRIENDLY CONSTRUCTION & DESIGN INC. NO PART OF THIS DRAWING OR ANY INFORMATION CONTAINED HEREIN IS TO BE REPRODUCED OR TRANSMITTED IN ANY FORM OR BY ANY MEANS, ELECTRONIC OR MECHANICAL, WITHOUT PERMISSION IN WRITING FROM ECO FRIENDLY CONSTRUCTION & DESIGN INC.



1600 Staley Avenue  
Savannah, GA 31405  
Office: (912) 344-4229  
ecofriendly.com

80% NOT VAL. UNLESS NOTED

NO.	Revision/Issue	Date

**PROPOSED FLOOR PLAN**

Project Name and Address  
1600 Staley Ave  
Savannah, Ga. 31405

Drawn: JI	Sheet: P-02
Date: 04/19/2023	Scale: 1/4" = 1'-0"