

FUTURE LAND USE

File: 24-005524-ZA
 File: 24-005471-ZA (Rezoning 20053 03005)
 File: 24-005474-ZA
 Address: 108, 112 E. Henry St. and/or
 1210 Drayton St.
 Savannah, Ga
 Aldermanic District: 2 - Leggett
 Commission District: 2 -Hodge
 Neighborhood: See Map
 Property ID: PIN: Various

* Newly annexed parcels may need
 Aldermanic & County Commission District
 determination

- Traditional Commercial
- Traditional Neighborhood
- Civic/Institutional



Date: 10/7/2024

CHATHAM COUNTY - SAVANNAH
 METROPOLITAN PLANNING COMMISSION
 110 E. STATE ST. SAVANNAH, GA 31412-2426 PHONE 912/297-1440

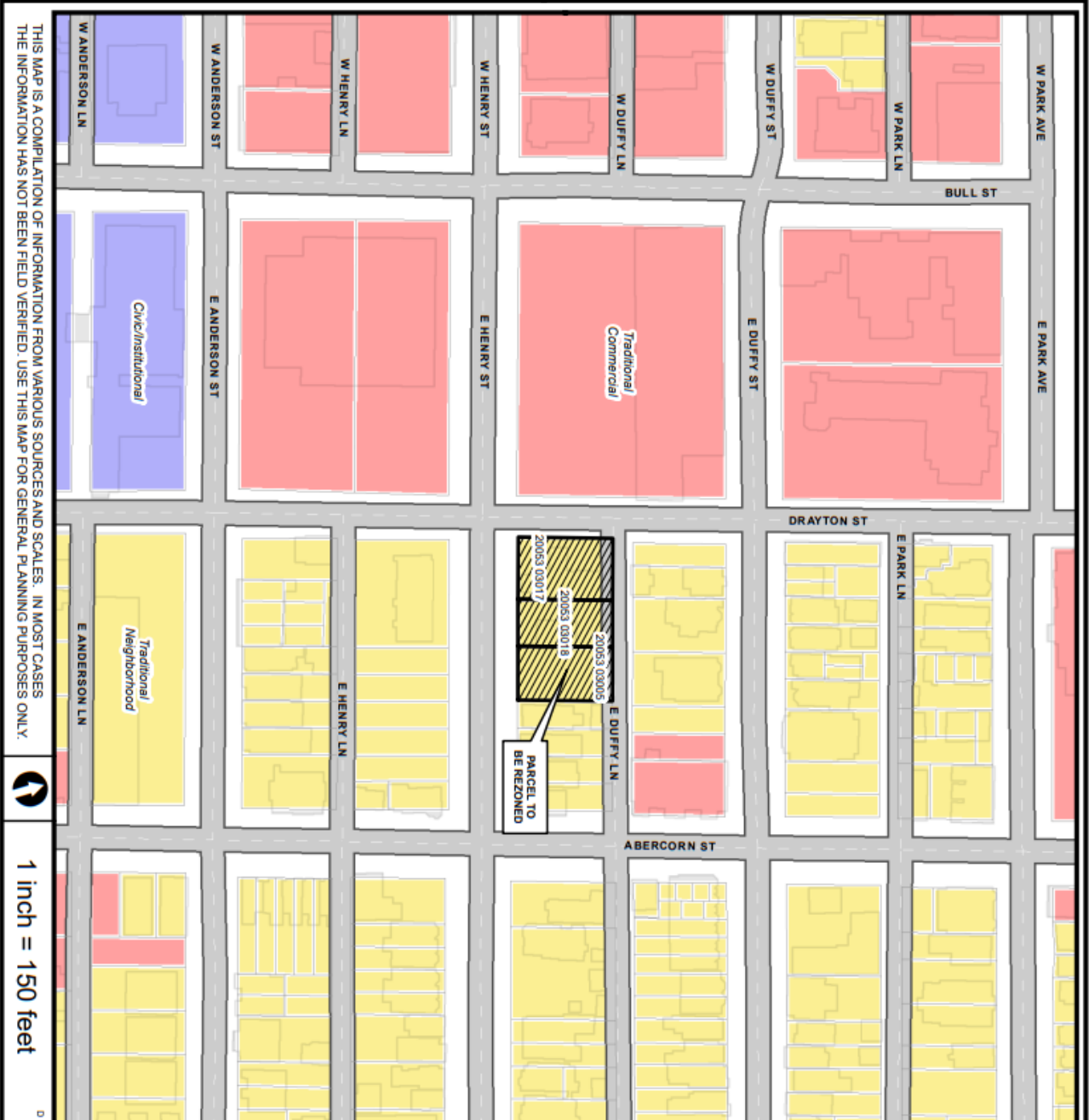

THIS MAP IS A COMPILATION OF INFORMATION FROM VARIOUS SOURCES AND SCALES. IN MOST CASES THE INFORMATION HAS NOT BEEN FIELD VERIFIED. USE THIS MAP FOR GENERAL PLANNING PURPOSES ONLY.

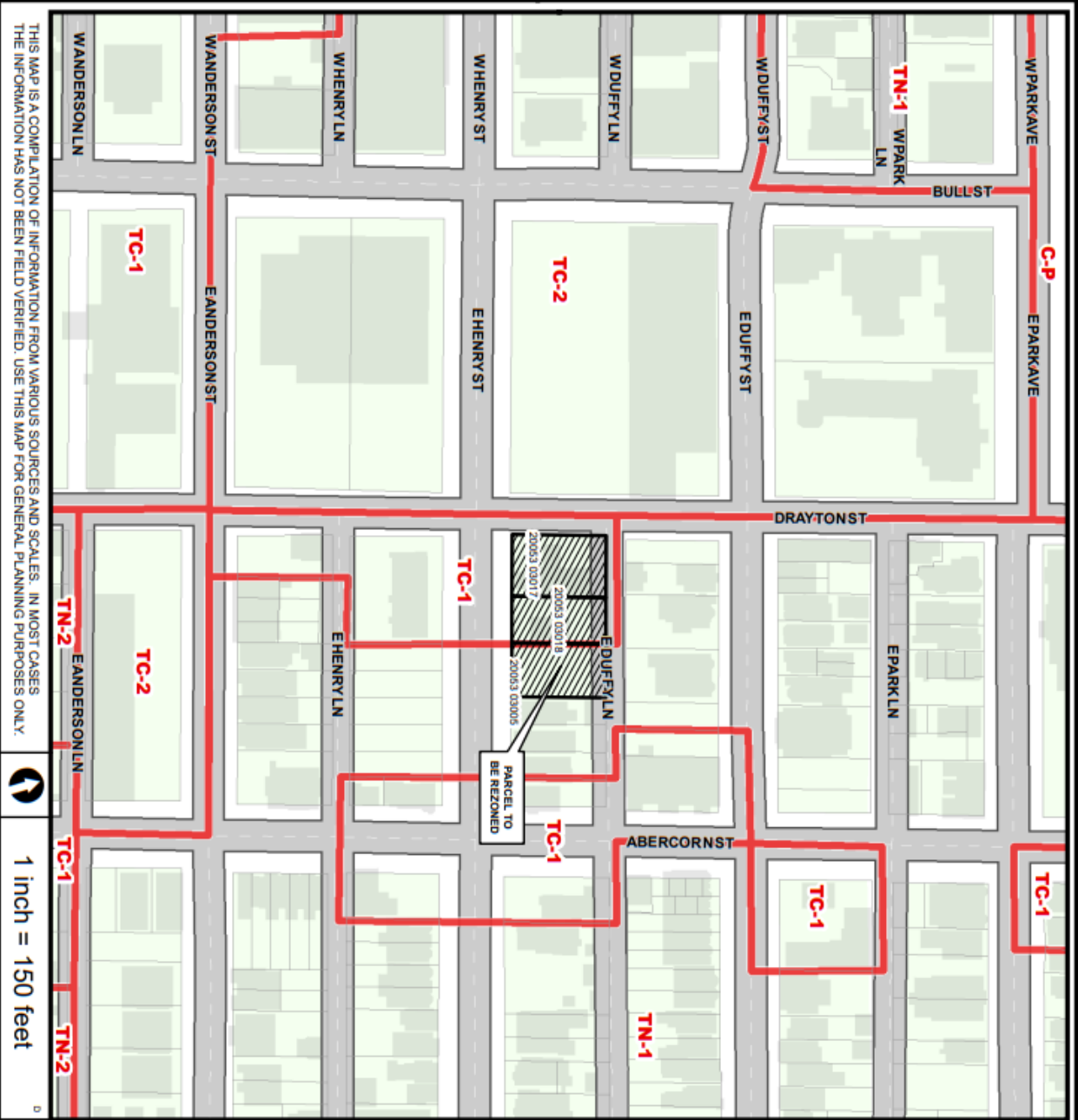

THIS MAP IS A COMPILATION OF INFORMATION FROM VARIOUS SOURCES AND SCALES. IN MOST CASES THE INFORMATION HAS NOT BEEN FIELD VERIFIED. USE THIS MAP FOR GENERAL PLANNING PURPOSES ONLY.



1 inch = 150 feet

ZONING MAP

WITH TAX PARCELS

File: 24-005524-ZA
 File: 24-005471-ZA (Rezoning 20053 03005)
 File: 24-005474-ZA
 Address: 108, 112 E. Henry St. and/or
 1210 Drayton St.
 Savannah, Ga
 Aldermanic District 2 - Leggett
 Commission District 2 - Hodge
 Neighborhood: See Map
 Property ID: PIN: Various

* Newly annexed parcels may need
 Aldermanic & County Commission District
 determination

ZONING

ZONING

DATE: 10/17/2024

CHATHAM COUNTY - SAVANNAH
 METROPOLITAN PLANNING COMMISSION
 119 E. STATE ST. SAVANNAH, GA 31415-5245 PHONE: 912-851-1443