

# VICINITY MAP

SPECIAL USE REQUEST

File: 23-005394-ZA  
 Address: 220 E. 41st St.  
 Savannah, Ga  
 Aldermanic District: 2 (Leggett)  
 Commission District: 2 (Rivers)  
 Neighborhood: Thomas Square  
 Property ID: 20075 08010 (portion)

Date: 11/13/2023



CHATHAM COUNTY - SAVANNAH  
 METROPOLITAN PLANNING COMMISSION  
 110 E. STATE ST. SAVANNAH, GA 31412-8246 PHONE 912-851-1400



THIS MAP IS A COMPILATION OF INFORMATION FROM VARIOUS SOURCES AND SCALES. IN MOST CASES THE INFORMATION HAS NOT BEEN FIELD VERIFIED. USE THIS MAP FOR GENERAL PLANNING PURPOSES ONLY.



1 inch = 1,000 feet

D



# AERIAL MAP

SPECIAL USE REQUEST

File: 23-005394-ZA  
Address: 220 E. 41st St.  
Savannah, Ga  
Aldermanic District: 2 (Leggett)  
Commission District: 2 (Rivers)  
Neighborhood: Thomas Square  
Property ID: 20075 08010 (portion)

Date: 11/13/2023



CHATHAM COUNTY · SAVANNAH  
METROPOLITAN PLANNING COMMISSION  
110 E. STATE ST. SAVANNAH, GA 31412-8248 PHONE 912-667-1440



THIS MAP IS A COMPILATION OF INFORMATION FROM VARIOUS SOURCES AND SCALES. IN MOST CASES THE INFORMATION HAS NOT BEEN FIELD VERIFIED. USE THIS MAP FOR GENERAL PLANNING PURPOSES ONLY.



1 inch = 50 feet

D



# ZONING MAP

SPECIAL USE REQUEST

File: 23-005394-ZA  
Address: 220 E. 41st St.  
Savannah, Ga  
Aldermanic District: 2 (Leggett)  
Commission District: 2 (Rivers)  
Neighborhood: Thomas Square  
Property ID: 20075 08010 (portion)

Date: 11/13/2023



CHATHAM COUNTY - SAVANNAH  
METROPOLITAN PLANNING COMMISSION  
110 E. STATE ST. SAVANNAH, GA 31402-8226 PHONE 912-651-1440

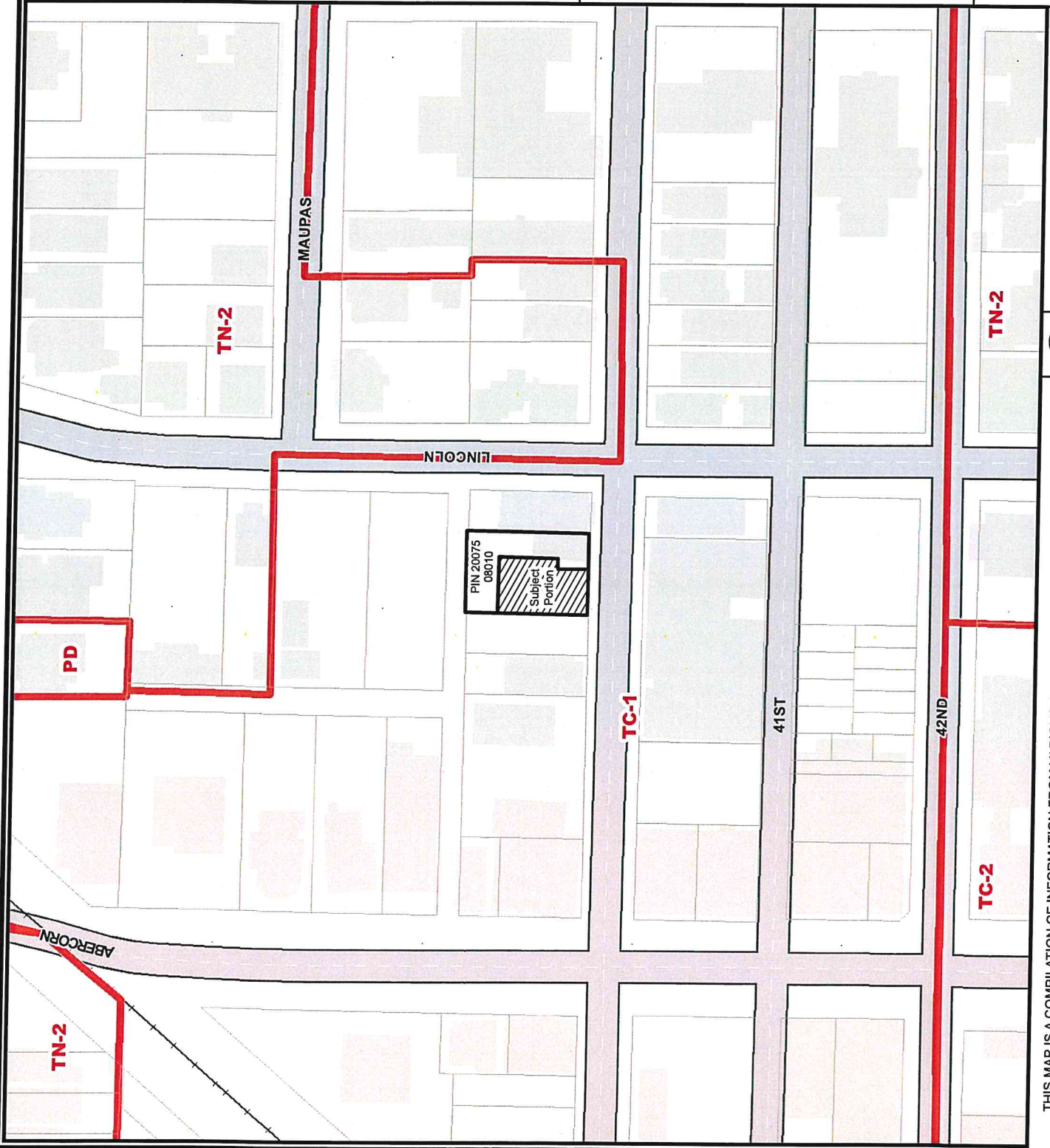

THIS MAP IS A COMPILATION OF INFORMATION FROM VARIOUS SOURCES AND SCALES. IN MOST CASES THE INFORMATION HAS NOT BEEN FIELD VERIFIED. USE THIS MAP FOR GENERAL PLANNING PURPOSES ONLY.



1 inch = 100 feet

D



# FUTURE LAND USE

SPECIAL USE REQUEST

File: 23-005394-ZA  
 Address: 220 E. 41st St.  
 Savannah, Ga  
 Aldermanic District: 2 (Leggett)  
 Commission District: 2 (Rivers)  
 Neighborhood: Thomas Square  
 Property ID: 20075 08010 (portion)

Date: 11/13/2023



CHATHAM COUNTY - SAVANNAH  
**METROPOLITAN PLANNING COMMISSION**  
 110 E. STATE ST. SAVANNAH, GA 31412-8246 PHONE 912-851-1440

- Traditional Commercial
- Traditional Neighborhood
- Residential- General

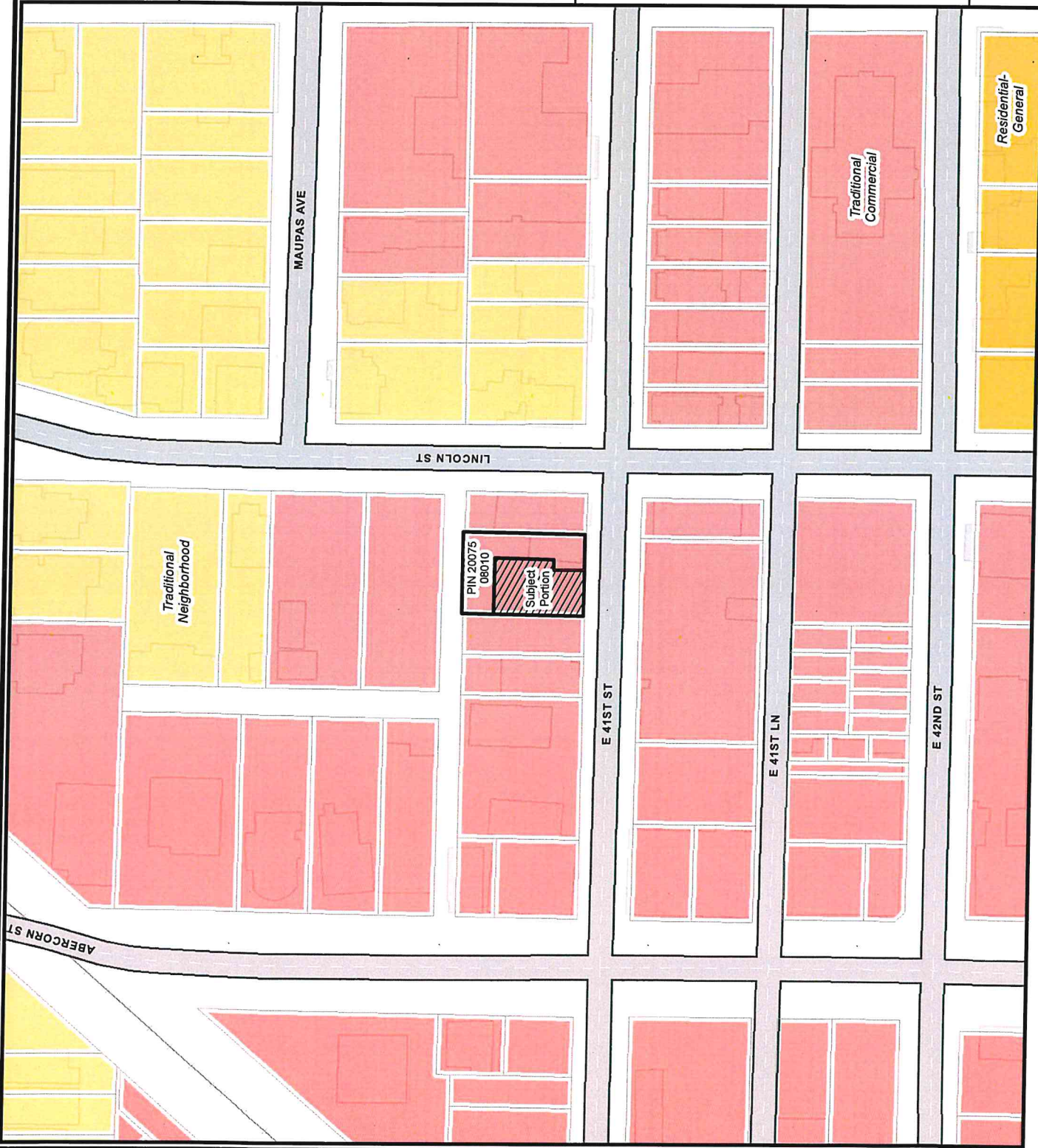

THIS MAP IS A COMPILATION OF INFORMATION FROM VARIOUS SOURCES AND SCALES. IN MOST CASES THE INFORMATION HAS NOT BEEN FIELD VERIFIED. USE THIS MAP FOR GENERAL PLANNING PURPOSES ONLY.



1 inch = 100 feet

Residential-  
General

Traditional  
Commercial

PIN 20075  
08010  
Subject  
Portion

Traditional  
Neighborhood

MAUPAS AVE

LINCOLN ST

E 41ST ST

E 41ST LN

E 42ND ST

ABERCORN ST

# TAX MAP

SPECIAL USE REQUEST

File: 23-005394-ZA  
Address: 220 E. 41st St.  
Savannah, Ga  
Aldermanic District: 2 (Leggett)  
Commission District: 2 (Rivers)  
Neighborhood: Thomas Square  
Property ID: 20075 08010 (portion)

Date: 11/13/2023



CHATHAM COUNTY - SAVANNAH  
METROPOLITAN PLANNING COMMISSION  
110 E. STATE ST. SAVANNAH, GA 31412-8246 PHONE 912-891-1440



THIS MAP IS A COMPILATION OF INFORMATION FROM VARIOUS SOURCES AND SCALES. IN MOST CASES THE INFORMATION HAS NOT BEEN FIELD VERIFIED. USE THIS MAP FOR GENERAL PLANNING PURPOSES ONLY.



1 inch = 50 feet

E 41ST LN

D



# LABEL MAP

SPECIAL USE REQUEST

File: 23-005394-ZA  
Address: 220 E. 41st St.  
Savannah, Ga  
Aldermanic District: 2 (Leggett)  
Commission District: 2 (Rivers)  
Neighborhood: Thomas Square  
Property ID: 20075 08010 (portion)

Baldwin Park  
NEIGHBORHOOD  
AREA

Thomas Square  
NEIGHBORHOOD  
AREA

Ardley Park/Chatham  
Crescent  
NEIGHBORHOOD  
AREA

CHATHAM COUNTY · SAVANNAH  
METROPOLITAN PLANNING COMMISSION  
110 E. STATE ST. SAVANNAH, GA 31412-8246 PHONE 912-651-1440



1 inch = 200 feet



Date: 11/13/2023

THIS MAP IS A COMPILATION OF INFORMATION FROM VARIOUS SOURCES AND SCALES. IN MOST CASES THE INFORMATION HAS NOT BEEN FIELD VERIFIED.  
**USE THIS MAP FOR GENERAL PLANNING PURPOSES ONLY.**

