

★ Highland Business Park Properties

★ Feeley Avenue Properties

★ East Broughton Street Properties

Highlands Business Park Properties

(PINs 2-1016 -02-087, -088, -091, -092, -093, -107, -108, -109, -110, -111, -113, -114, -115, -116 & -117)

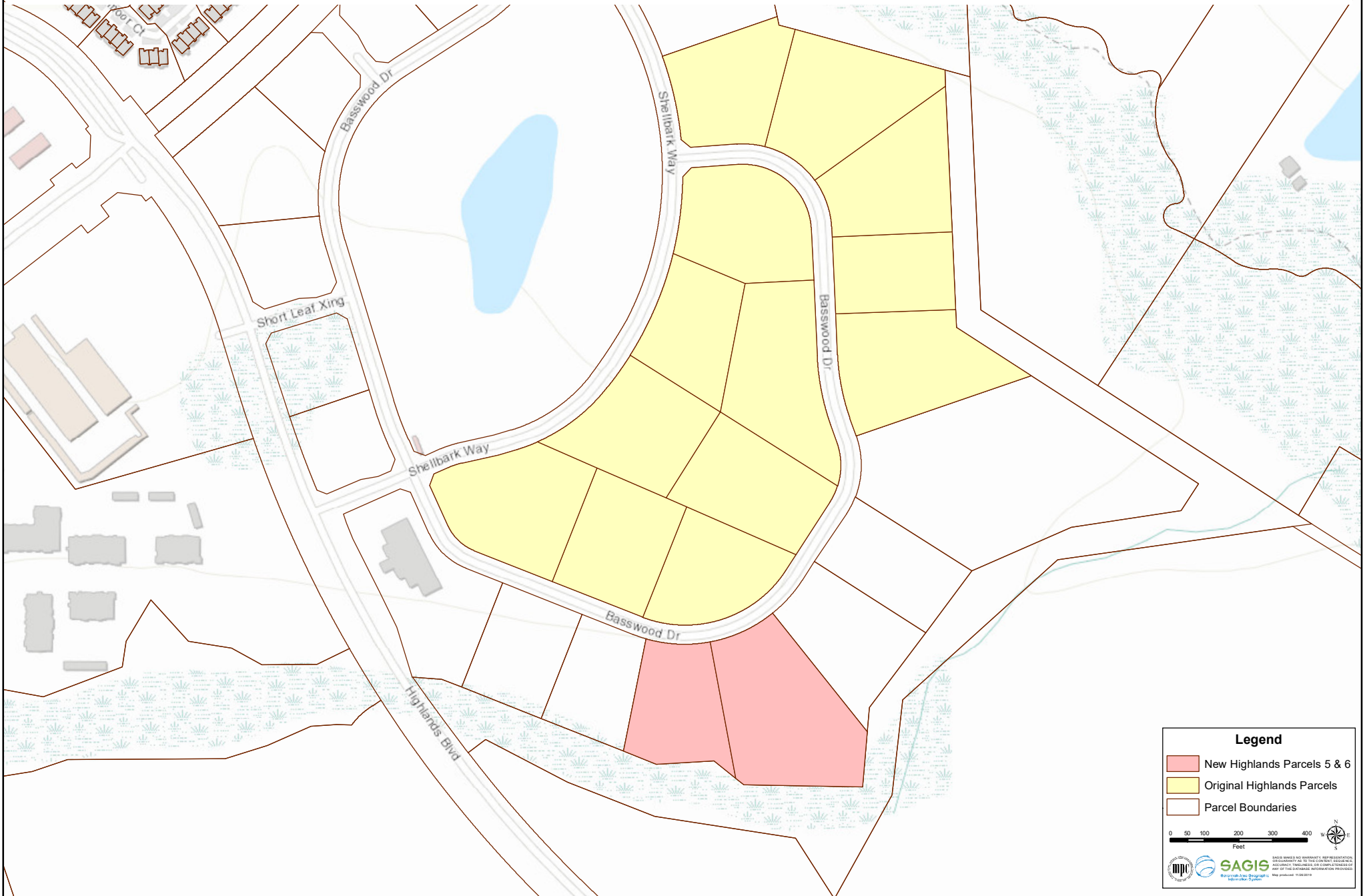

Legend

- New Highlands Parcels 5 & 6
- Original Highlands Parcels
- Parcel Boundaries

0 50 100 200 300 400 Feet

SAGIS Software and Systems

BASED UPON AERIAL PHOTOGRAPHY. REPRESENTATION OF PARCELS IS TO THE BEST OF OUR KNOWLEDGE AND BELIEF. ACCURACY CANNOT BE GUARANTEED. ANY AND ALL INFORMATION IS SUBJECT TO CHANGE WITHOUT NOTICE.

Map produced: 11/08/2018

Feely Avenue Properties

- 2-0047-01-001
 - 2-0047-02-002, -003, -004
 - 2-0047-06-002, -003
 - 2-0047-08-001, -002, -003, -004
 - 2-0048-01-001
 - 2-0048-02-001, -002
 - 2-0048-03-001, -002, -003, -004
 - 2-0598-02-006, -012
 - 2-0598-07-001
- + Plus the right-of-way of unopened Travis Avenue and Stephens Avenue (.964 acre)

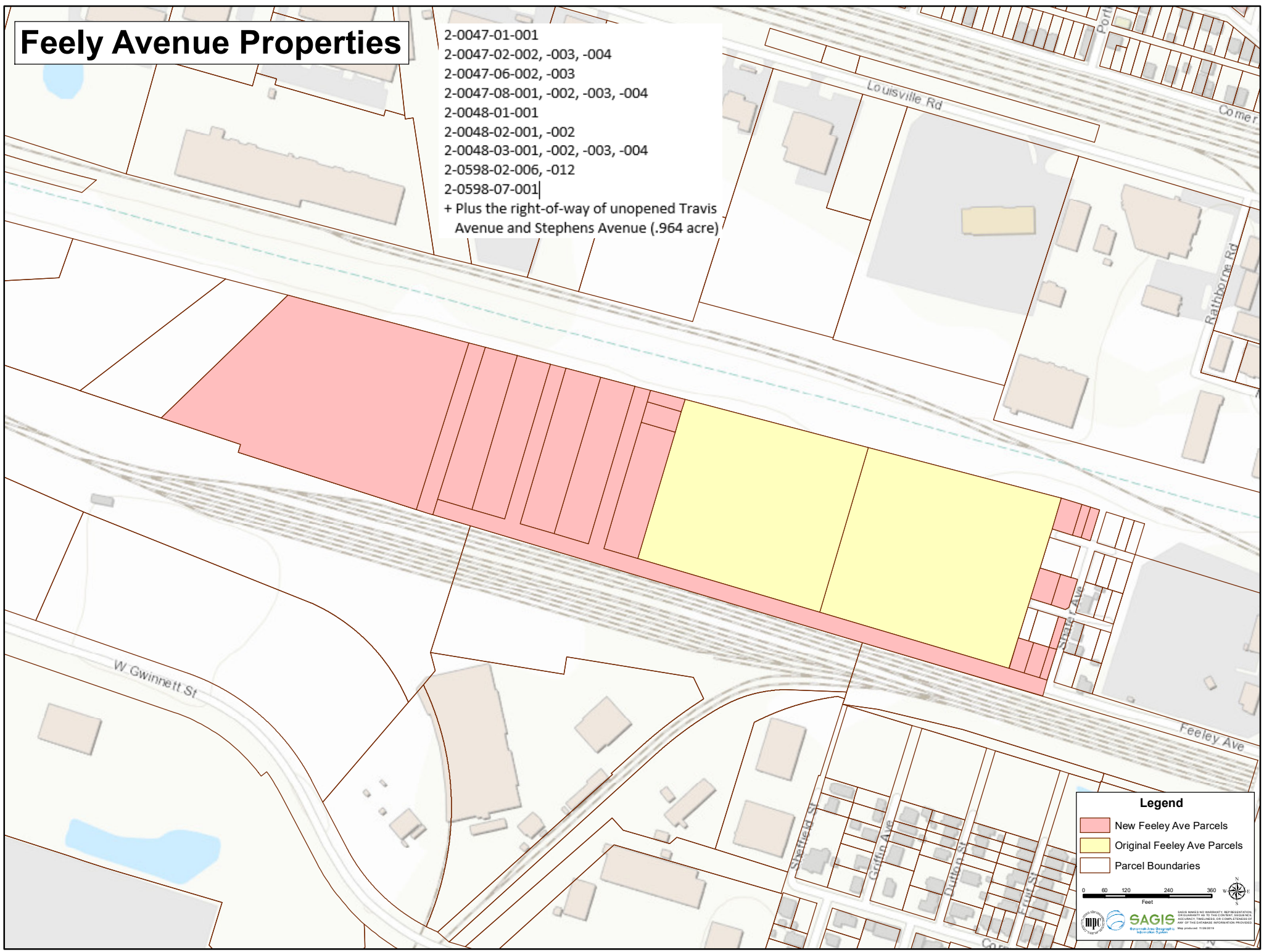

Legend

- New Feeley Ave Parcels
- Original Feeley Ave Parcels
- Parcel Boundaries

0 60 120 240 360 Feet

SAGIS
Spatial Analysis and Geographic Information System

BASED UPON AERIAL PHOTOGRAPHS. REPRESENTATIONS ARE MADE BY THE COUNTY ENGINEERS. ACCURACY THROUGHOUT THE COUNTY. STUDIES OF AIR PHOTOGRAPHS AVAILABLE FOR REVIEW.

Map produced: 11/08/2018

East Broughton Street Properties

2-0005-20-001, 002, 003, 005, 006

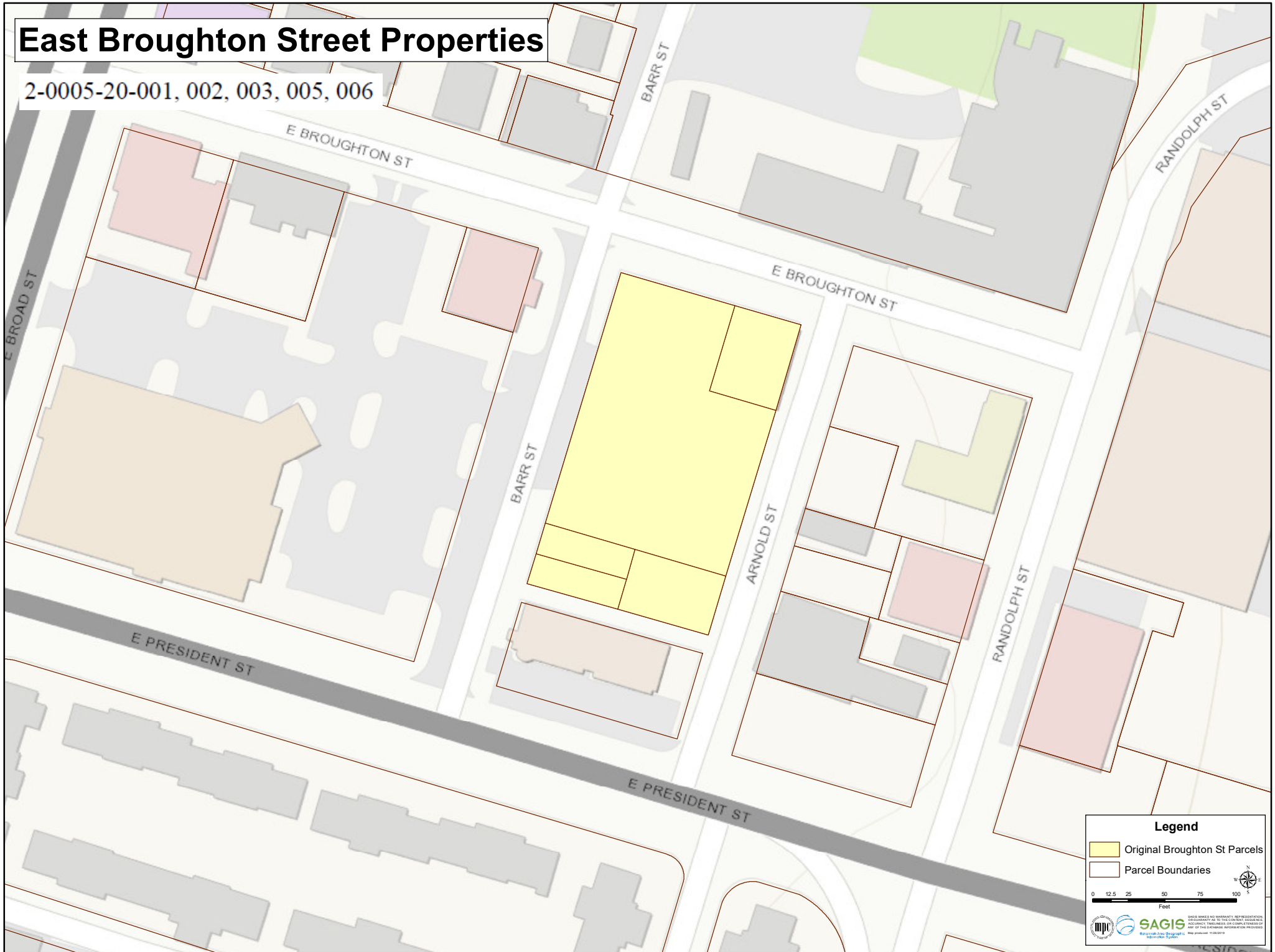

Legend

- Original Broughton St Parcels
- Parcel Boundaries

0 12.5 25 50 75 100 Feet

BASED UPON: NO WARRANTY, REPRESENTATION OR ASSURANCE IS MADE BY THE COUNTY ENGINEER, ASSISTANT ENGINEER OR CIVIL ENGINEER OF ANY OF THE SERVICES AND/OR INFORMATION PROVIDED. Map produced: 11/08/2018