

ZONING MAP

20-005549-ZA
122 E. 37th St.
Savannah, Ga
Aldermanic District: 2 (Leggett)
Commission District: 2 (Holmes)
Neighborhood: Thomas Square
District Area
PIN(s): See Map

City of Savannah Needs Zoning When Applicable

Date: 11/19/2020



CRATHAM COUNTY - SAVANNAH
METROPOLITAN PLANNING COMMISSION
110 E. STATE ST. SAVANNAH, GA 31412-5248 PHONE 912.651.1440

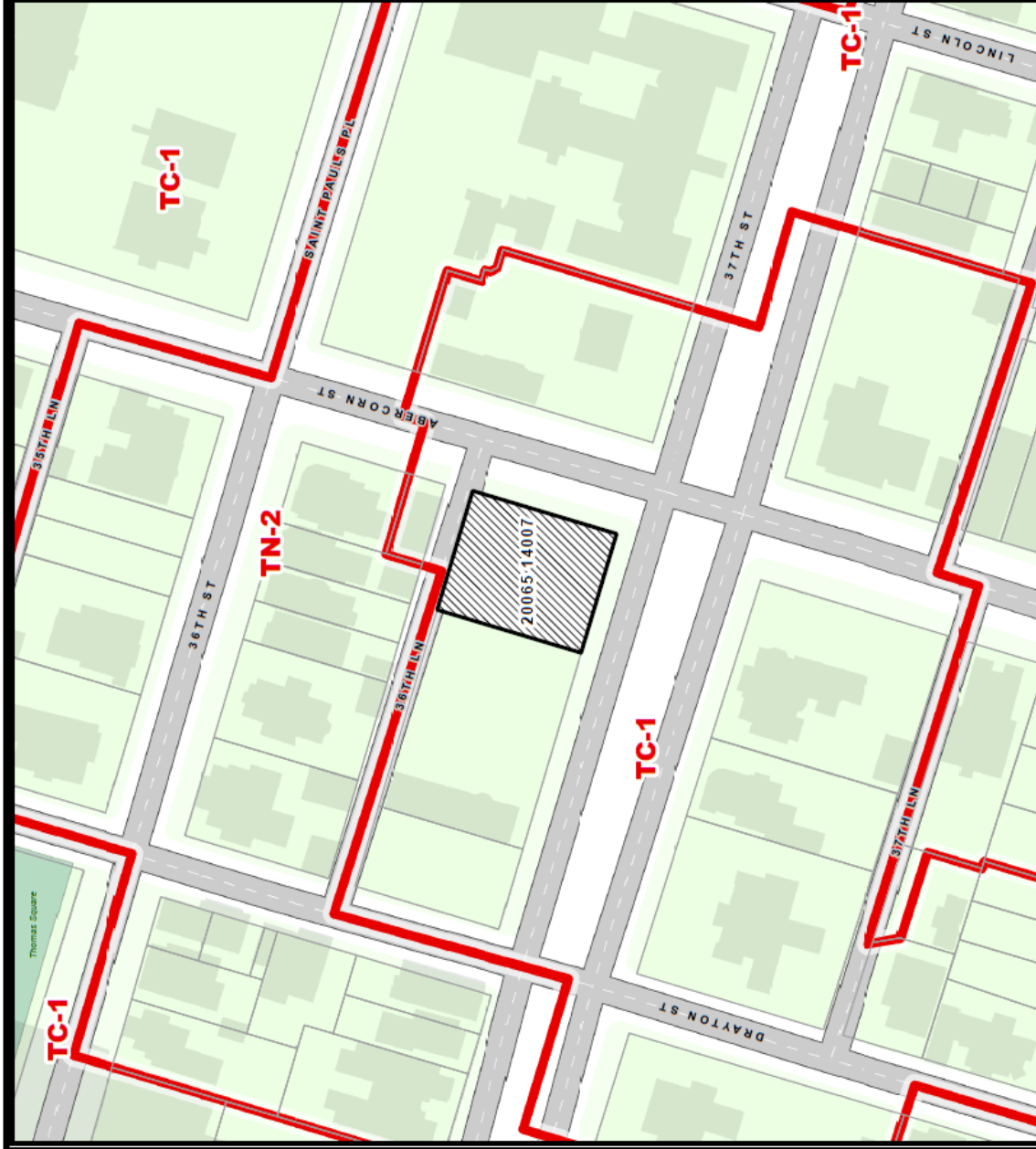

1 inch = 100 feet

THIS MAP IS A COMPILATION OF INFORMATION FROM VARIOUS SOURCES AND SCALES. IN MOST CASES THE INFORMATION HAS NOT BEEN FIELD VERIFIED. USE THIS MAP FOR GENERAL PLANNING PURPOSES ONLY.