

GENERAL

- PLANS WILL NEED TO BE VERIFIED BY A STRUCTURAL ENGINEER
- A WORK IN THE RIGHT-OF-WAY PERMIT IS REQUIRED. THIS PERMIT TAKES FOUR BUSINESS DAYS TO PROCESS. THERE IS NO FEE FOR THIS PERMIT. PLEASE CONTACT TRAFFIC ENGINEERING AT 912.463.6600. IT IS THE RESPONSIBILITY OF THE CONTRACTOR TO KEEP THE PERMIT UP TO DATE. THE CONTRACTOR CANNOT BEGIN WORK UNTIL THEY RECEIVE THIS PERMIT.
- CALL 811 BEFORE YOU DIG. CONTRACTOR IS REQUIRED TO OBTAIN A UTILITY LOCATE (DIG TICKET) BEFORE EXCAVATION AND KEEP THE DIG TICKET UPDATED.
- THE SIGN LOCATION WILL NEED TO BE STAKED BY THE CONTRACTOR AND APPROVED BY TRAFFIC ENGINEERING BEFORE EXCAVATION WORK CAN OCCUR.
- SUBMIT BRICK, MORTAR, AND CAP COLOR TO THE OWNER FOR APPROVAL PRIOR TO ORDERING.
- SUBMIT SHOP DRAWING OF THE SIGN INSERT TO OWNER FOR APPROVAL PRIOR TO FABRICATION.
- GRASS AND MULCH ALL DISTURBED AREAS. REMOVE ALL EXCESS SOIL.
- ALL CONSTRUCTION SHALL CONFORM TO THE INTERNATIONAL BUILDING CODE CURRENTLY ADOPTED BY THE CITY OF SAVANNAH. REFERENCE TO OTHER SPECIFICATIONS OR CODES SHALL MEAN THE LATEST STANDARD OR CODE ADOPTED OR PUBLISHED.
- DRAWING SHOW TYPICAL AND CERTAIN SPECIFIC CONDITIONS ONLY. FOR DETAILS NOT SPECIFICALLY SHOWN PROVIDE DETAILS SIMILAR TO THOSE SHOWN.
- VERIFY ALL EXISTING CONDITIONS, DIMENSIONS, AND ELEVATIONS BEFORE STARTING WORK. NOTIFY THE OWNER OF ANY DISCREPANCY.
- THE CONTRACTOR IS SOLEY RESPONSIBLE FOR THE DESIGN, ADEQUACY, AND SAFETY OR ERECTION BRACING, SHORING, TEMPORARY SUPPORTS, ETC. THE STRUCTURAL ELEMENTS ARE NOT TABLE UNTIL THE STRUCTURE IS COMPLETE.
- REVIEW OF SHOP DRAWINGS OR OTHER SUBMITTALS BY THE OWNER DOES NOT RELIEVE THE CONTRACTOR OF RESPONSIBILITY TO REVIEW AND CHECK SHOP DRAWINGS BEFORE SUBMITTAL TO THE OWNER. THE CONTRACTOR REMAINS SOLEY RESPONSIBLE FOR ERRORS AND OMISSIONS ASSOCIATED WITH THE PREPERATION OF SHOP DRAWINGS AS THEY PERTAIN TO MEMBER SIZES, DETAILS, AND DIMENSION SPECIFIED IN THE CONTRACTOR DOCUMENTS.
- THE CONTRACTOR IS SOLEY RESPONSIBLE FOR THE MEANS, METHODS, TECHNIQUES, SEQUENCES AND OPERATIONS OF CONSTRUCTION AND SAFETY PRECAUTIONS PROGRAMS INCIDENTAL THERE TO.
- USE ONLY DIMENSIONS INDICATED ON THE DRAWINGS. DO NOT SCALE DRAWINGS OR USE ANY DIMENSIONS TAKEN FROM ELECTRONIC DRAWING FILES.
- THE CONTRACTORS SHALL FURNISH ALL LABOR, MATERIALS, AND EQUIPMENT FOR SUCCESSFUL COMPLETION OF THE PROJECT.
- THE CONTRACTOR SHALL NOTIFY THE OWNER IMMEDIATELY OF ANY DISCREPANCIES BETWEEN THE PLANS AND ANY OTHER DOCUMENTS OR EXISTING CONDITIONS FOR RESOLUTION PRIOR TO PROCEEDING WITH THE WORK.
- THE SPECIFICATIONS ARE AN INTEGRAL PART OF THE CONTRACT DOCUMENTS AND SHALL BE USED IN CONJUNCTION WITH THE DRAWINGS. IN CASES, IF ANY, WHERE REQUIREMENTS INDICATED ON THE DRAWINGS DIFFER FROM THE SPECIFICATIONS, NOTIFY THE OWNER, FOR PRICING, ASSUME THE MORE STRINGENT REQUIREMENT.
- THE LOCATION OF ANY UTILITIES ON THE DRAWINGS ARE APPROXIMATE. MAY BE INCOMPLETE, AND THOSE SHOWN ARE NOT NECESSARILY ALL OF THE EXISTING UTILITIES AND STRUCTURES. VERIFICATION OF EXCAT LOCATIONS SHOULD BE MADE PRIOR TO ANY CONSTRUCTION.
- COMPACTION REQUIREMENTS: COMACTED TO 95% DENSITY IN ACCORDANCE WITH ASTM-D-1557.

CONCRETE SPECIFICATIONS:

- ALL CONCRETE WORK SHALL CONFORM TO AC 301. *SPECIFICATION FOR STRUCTURAL CONCRETE FOR BUILDINGS, LATEST EDITION.
- UNLESS OTHERWISE NOTED ALL CONCRETE SHALL BE NORMAL WEIGHT AND HAVE THE FOLLOWING MINIMUM 28 DAY STRENGTHS:
- FOUNDATION _____ 4000 PSI
- CONCRETE MIX DESIGNS SHALL BE SUBMITTED TO THE ENGINEER AND THE OWNER'S TESTING LAB FOR APPROVAL
- RESPONSIBILITY FOR OBTAINING THE REQUIRED CONCRETE DESIGN STRENGTH IS THE RESPONSIBILITY OF THE CONTRACTOR
- USE OF CALCIUM CHLORIDE, CHORLUDE IONS, OR OTHER SALTS IN CONCRETE IS NOT PERMITTED. THE USE OF RECYCLED CONCRETE IS NOT PERMITTED.
- COLD JOINTS ARE NOT PERMITTED
- COAT ALL SLABS WITH CURING COMPOUND WITHIN 24 HOURS OF PLACING. PRODUCT USED SHALL CONFORM WITH ASTM C309 AND SHALL BE COMPATIBLE WITH ADHERED FINISHES. A SSISSIPATING FORMULATION SHALL BE USED AT CEMENTIOUS FINISHES.
- THE CONTRACTOR SHALL COMPLETE THE FOUNDATION IS ONE POUR. EACH TRUCK WILL BE SAMPLED IN ACCORDANCE WITH ASTM C172. PERFORMTHE FOLLOWING TESTS IN ACCORDANCE WITH THE INDICATED STANDARD:

- DRAWING SHOW TYPICAL AND CERTAIN SPECIFIC CONDITIONS ONLY. FOR DETAILS NOT SPECIFICALLY SHOWN PROVIDE DETAILS SIMILAR TO THOSE SHOWN.

- VERIFY ALL EXISTING CONDITIONS, DIMENSIONS, AND ELEVATIONS BEFORE STARTING WORK. NOTIFY THE OWNER OF ANY DISCREPANCY.
- THE CONTRACTOR IS SOLEY RESPONSIBLE FOR THE DESIGN, ADEQUACY, AND SAFETY OR ERECTION BRACING, SHORING, TEMPORARY SUPPORTS, ETC. THE STRUCTURAL ELEMENTS ARE NOT TABLE UNTIL THE STRUCTURE IS COMPLETE.
- REVIEW OF SHOP DRAWINGS OR OTHER SUBMITTALS BY THE OWNER DOES NOT RELIEVE THE CONTRACTOR OF RESPONSIBILITY TO REVIEW AND CHECK SHOP DRAWINGS BEFORE SUBITAL TO THE OWNER. THE CONTRACTOR REMAINS SOLEY RESPONSIBLE FOR ERRORS AND OMISSIONS ASSOCIATED WITH THE PREPARATION OF SHOP DRAWINGS AS THEY PERTAIN TO MEMBER SIZES, DETAILS, AND DIMENSION SPECIFIED IN THE CONTRACTOR DOCUMENTS.
- THE CONTRACTOR IS SOLEY RESPONSIBLE FOR THE MEANS, METHODS, TECHNIQUES, SEQUENCES AND OPERATIONS OF CONSTRUCTION AND SAFETY PRECAUTIONS PROGRAMS INCIDENTAL THERE TO.

- USE ONLY DIMENSIONS INDICATED ON THE DRAWINGS. DO NOT SCALE DRAWINGS OR USE ANY DIMENSIONS TAKEN FROM ELECTRONIC DRAWING FILES.
- THE CONTRACTORS SHALL FURNISH ALL LABOR, MATERIALS, AND EQUIPMENT FOR SUCCESSFUL COMPLETION OF THE PROJECT.
- THE CONTRACTOR SHALL NOTIFY THE OWNER IMMEDIATELY OF ANY DISCREPANCIES BETWEEN THE PLANS AND ANY OTHER DOCUMENTS OR EXISTING CONDITIONS FOR RESOLUTION PRIOR TO PROCEEDING WITH THE WORK.
- THE SPECIFICATIONS ARE AN INTEGRAL PART OF THE CONTRACT DOCUMENTS AND SHALL BE USED IN CONJUNCTION WITH THE DRAWINGS. IN CASES, IF ANY, WHERE REQUIREMENTS INDICATED ON THE DRAWINGS DIFFER FROM THE SPECIFICATIONS, NOTIFY THE OWNER, FOR PRICING, ASSUME THE MORE STRINGENT REQUIREMENT.
- THE LOCATION OF ANY UTILITIES ON THE DRAWINGS ARE APPROXIMATE. MAY BE INCOMPLETE, AND THOSE SHOWN ARE NOT NECESSARILY ALL OF THE EXISTING UTILITIES AND STRUCTURES. VERIFICATION OF EXCAT LOCATIONS SHOULD BE MADE PRIOR TO ANY CONSTRUCTION.
- COMPACTION REQUIREMENTS: COMACTED TO 95% DENSITY IN ACCORDANCE WITH ASTM-D-1557.

CONCRETE SPECIFICATIONS:

- ALL CONCRETE WORK SHALL CONFORM TO AC 301. *SPECIFICATION FOR STRUCTURAL CONCRETE FOR BUILDINGS, LATEST EDITION.
- UNLESS OTHERWISE NOTED ALL CONCRETE SHALL BE NORMAL WEIGHT AND HAVE THE FOLLOWING MINIMUM 28 DAY STRENGTHS:
- FOUNDATION _____ 4000 PSI
- CONCRETE MIX DESIGNS SHALL BE SUBMITTED TO THE ENGINEER AND THE OWNER'S TESTING LAB FOR APPROVAL
- RESPONSIBILITY FOR OBTAINING THE REQUIRED CONCRETE DESIGN STRENGTH IS THE RESPONSIBILITY OF THE CONTRACTOR
- USE OF CALCIUM CHLORIDE, CHORLUDE IONS, OR OTHER SALTS IN CONCRETE IS NOT PERMITTED. THE USE OF RECYCLED CONCRETE IS NOT PERMITTED.
- COLD JOINTS ARE NOT PERMITTED
- COAT ALL SLABS WITH CURING COMPOUND WITHIN 24 HOURS OF PLACING. PRODUCT USED SHALL CONFORM WITH ASTM C309 AND SHALL BE COMPATIBLE WITH ADHERED FINISHES. A SSISSIPATING FORMULATION SHALL BE USED AT CEMENTIOUS FINISHES.
- THE CONTRACTOR SHALL COMPLETE THE FOUNDATION IS ONE POUR. EACH TRUCK WILL BE SAMPLED IN ACCORDANCE WITH ASTM C172. PERFORMTHE FOLLOWING TESTS IN ACCORDANCE WITH THE INDICATED STANDARD:
- SLUMP: ASTM C143
- AIR CONTENT: ASTM C173
- COMPRESSIVE STRENGTH: ASTM C39. WITH ONE CYLINDER AT 7 DAYS, 2 CYLINDERS AT 28 DAYS AND ONE SPECIMAN HELD IN RESERVE
- PROVIDE NORMAL WEIGHT CONCRETE WITH MINIMUM CURED DENSITY OF 145 PCF. AND AGGREGATE CONFORMING TO ASTM C33. UNLESS OTHERWISE NOTED.
- CONCRETE SHALL ONLY BE POURED WHEN THE TEMPERATURE IS 40 F OR RISING.
- CONCRETE PLACEMENT AT TEMPERATURES GREATER THAN 90 F SHALL BE DONE USING HOT WEATHER PLACEMENT AS PER ACI.

REINFORCEMENT

- PROVIDE CONTINUOUS REINFORCEMENT WHERE EVER POSSIBLE. SPICE ONLY AS SHOWN OR APPROVED. STAGGER SPICES WHERE POSSIBLE: USE TENSION SPICE (CLASS "B") UNLESS NOTED OTHERWISE. DOWELS SHALL MATCH THE SIZE AND SPACING OF THE SPECIFIED REINFORCEMENT AND SHALL BE LAPPED WITH TENSION SPICES (CLASS "B") UNLESS OTHERWISE NOTE LAP LENGTHS EXPRESSED IN NUMBER OF BAR DIAMETERS SHALL BE AS FOLLOWS:

BAR SIZE	NORMAL WEIGHT, F.C (PSI)			
	3,000	4,000	5,000	6,000
#6 OR SMALLER	57 DIAM	49 DIAM	44 DIAM	40 DIAM
#7 OR	71 DIAM	62 DIAM	55 DIAM	50 DIAM

- REINFORCING STEEL SHALL HAVE THE FOLLOWING CONCRETE COVER UNLESS NOTED OTHERWISE:

- CONCRETE CAST AGAINST EARTH (NOT FORMED) _____ 3"
- FORMED CONCRETE EXPOSED TO EARTH OR WEATHER
- #6 THROUGH #18 BARS _____ 2"
- #5 BARS AND SMALLER _____ 1 1/2"

- DO NOT WELD OR TACK WELD REINFORCING STEEL UNLESS APPROVED OR DIRECTED BY THE ENGINEER
- REINFORCEMENT SHALL CONFORM TO ASTM A 615, GR 60.
- DETAIL REINFORCEMENT BASED ON THE PROJECT REQUIREMENTS, ACI-318 AND ACI-315.
- WHERE A 90 DEG. HOOK IS GRAPHICALLY INDICATED, PROVIDE ACI STANDARD 90 DEG. HOOK
- ASSUME EQUAL SPACING IF NOT INDICATED ON DRAWINGS

MASONRY:

- PROVIDE MATERIALS IN ACCORDANCE WITH THE CONTRACT DOCUMENTS, AS SPECIFIED HEREIN, AND AS NEEDED FOR A COMPLETE AND PROPER INSTALLATION.

- MORTAR AND MORTAR MATERIALS SHALL CONFORM TO THE FOLLOWING STANDARDS:

- MORTAR: ASTM C270. MORTAR SHALL BE TYPE S.
- GROUT: ASTM C476
- CONCRETE BLOCK: ASTM C90, NORMAL WEIGHT - TYPE I
- REINFORCING BARS: ASTM A615, GRADE 60
- JOINT REINF: ASTM A82, TRUSS OR LADDER TYPE
- EXTERIOR JT REINF: GALVANIZE PER ASTM A153
- INTERIOR JT REINF: GALVANIZE PER ASTM A641
- USE ONLY POTABLE WATER
- DO NOT ADD ANTIFREEZE OR ACCELERATING COMPOUNDS TO THE MORTAR.
- CALCIUM CHLORIDE SHALL NOT BE USED IN MORTAR OR GROUT

- ALL MASONRY WALLS SHALL HAVE HORIZONTAL JOINT REINFORCEMENT AT 16" OC MAXIMUM. HORIZONTAL JOINT REINFORCING AND ACCESSORIES SHALL BE TWO PIECE TYPE SIMILAR TO DUB-O-WALL 210/700. WIRE TO CONFORM TO ASTM A82. WIRE SHALL BE GALVANIZED CONFORMING TO ASTM G41 CLASS 1 (04 OZ ZINC/FS.F)
- THE MINIMUM COMPRESSIVE STRENGTH OF THE MAONRY (FM) SHALL BE 1,500 PSI. UNLESS OTHERWISE NOTED, THE STRENGTH SHALL BE BRANDED IN ACCORDANCE WITH THE ABOVE REFERENCED SPECIFICATIONS FOR MASONRY STRUCTURES.
- ALL MASONRY UNITS SHALL BE PLACED WITH FULL FACESHELL MORTAR COVERAGE ON HORIZONTAL AND VERTICAL JOINTS. WEBS SHALL ALSO HAVE FULL MORTAR COVERAGE AROUND ALL GROUTED CELLS.
- ALL CELLS WITH VERTICAL REINFORCING SHALL BE GROUTED SOLID.
- CMU BOND BEAMS WITH (2) #5 CONT SHALL BE PLACED AT 4'-0" MAXIMUM CENTERS.
- PROVIDE CONTROL JOINTS AT 20' O.C MAX AND AT EACH SIDE OF EACH IN CMU WALLS. FILL JOINTS WITH WEATHERROOF-ELASTOMERIC SEALANT MEETING STANDARDS OF ASTM C920.
- LAY MASONRY UNITS PLUMB AND NEAT TO LINE, WITH LEVEL HORIZONTAL JOINTS.
- KEEP THE OPEN SPACE AT EXPANSION AND CONTROL JOINS FREE OF MORTAR BY USING CONTINUOUS WOOD OR METAL STRIP SET TEMPORARILY IN THE WALLS.
- IF NECESSARY TO "STOP-OFF" A HORIZONTAL RUN OF MASONRY, RACK BY HALF LENGTH IN EACH COURSE. TOOTHING WILL NOT BE PERMITTED. WHEN WORK IS RESUMED, REMOVE LOOSE UNITS AND CLEAN CONTACT SURFACES OF ALL MORTAR AND DEBRIS.
- DO NOT WET UNIT PRIOR TO SETTING. HOWEVER, IN DRYING WEATHER BRUSH, A SMALL AMOUNT OF WATER ON CONTACT SURFACES TO OBTAIN A GOOD BOND.
- KEEP THE RUNNING BOND, UNLESS NOTED ELSE WHERE ON THE DRAWINGS.
- LAY UNITS WITH FULL MORTAR COVERAGE ON HORIZONTAL AND VERTICAL FACE SHELS. MAKE JOINTS UNIFORM, APPROXIMATELY 3/8" THICK.
- WHEN FINISHED, WORK WILL BE EXPOSED TO VIEW. CUT JOINTS FLUSH AND TOOL WHEN "THUMB-PRINT" HARD TO FORM A SLIGHTLY CONCAVE JOINT. WHEN TOOLING JOINTS, USE PRESURE TO PRESS THE MORTAR AGAINST BOTH SIDES OF THE JOINT. CUT FLUSH ALL JOINTS WHICH WILL NOT BE EXPOSED TO VIEW. POINT UP ALL HOLES IN MORTAR. CUT OUT DEFECTIVE JOINTS AND REPOINT.
- DO NOT LAY MASONRY WHEN TEMPERATURE OF AIR IS BELOW 40 DEGREES F, UNLESS SUITABLE MEANS, APPROVED BY THE OWNER ARE PROVIDED TO HEAT MATERIALS.
- PROTECT FINISHED WORK FROM COLD AND FROST AND INSURE THAT MORTAR WILL HARDEN WITH OUT FREEZING. DESIGN AND ERECT SCAFFOLDING SUFFICIENTLY AWAY FROM THE WALLS SO THAT MORTAR SPLATTER FROM DRIPPINGS WILL NOT AFFECT FACE OF WALL.
- CLEAN EXPOSED MASONRY OF ALL STAINS AND LOOSE MORTAR BY FREQUENTLY BRUSHING SURFACE WITH A MASON'S BRUSH.
- DO NOT WET CONCRETE MASONRY UNTIL MORTAR HAS THOROUGHLY SET. CLEAN MASONRY IN ACCORDANCE WITH BRICK INSTITUTE OF AMERICA. *TECHNICAL NOTES #20 RECOMMENDATIONS AND IN ACCORDANCE WITH BRICK MANUFACTURER'S INSTRUCTIONS.

Project Title:

Sylvan Terrace
Neighborhood Sign

Savannah, Georgia

Drawing Title:

General Notes



DEVELOPMENT
SERVICES
DEPARTMENT

CIP Management
5515 Abercorn Street
Savannah, GA
31405
912 - 351 - 3409

Notes:

USE OF THESE FILES AND DRAWINGS CONSTITUTE RECIPIENT'S AGREEMENT TO THE FOLLOWING:

THIS MEDIA IS RESTRICTED TO THE ORIGINAL SITE FOR WHICH IT WAS BE TRANSFERRED TO ANY OTHER PARTY OR REPRODUCTION OF THE DOCUMENTS FOR ANY PURPOSE OTHER THAN THAT FOR WHICH IT WAS INTENDED IS STRICTLY PROHIBITED.

Dwg. by: DCG
Cld. by:
Date: 9/25/18

Project Number:

Sheet Number:

G1.0

Architectural

1
General Notes

Scale: N.T.S.

FAIRFAX DR.

MONTEREY AVE.

MONTEREY AVE.

OAKVIEW DR.

OAKVIEW DR.

BULL ST.

BULL ST.

E 65TH ST.

Proposed Sign
Location for:
SYLVAN TERRACE
NEIGHBORHOOD

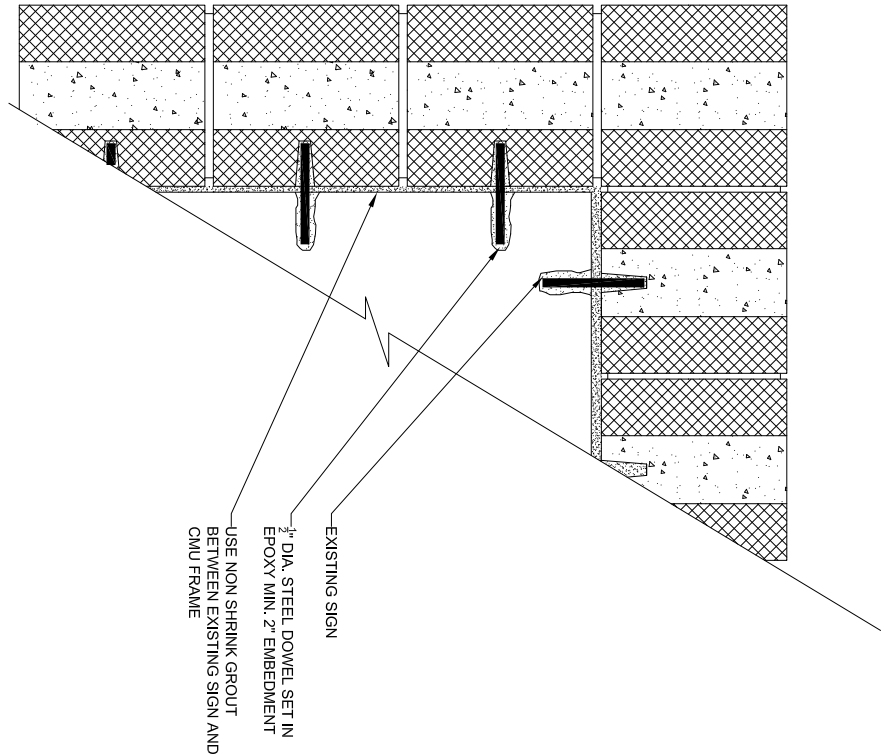

4
A1.1
Detail
Scale: 3" - 1'-0"

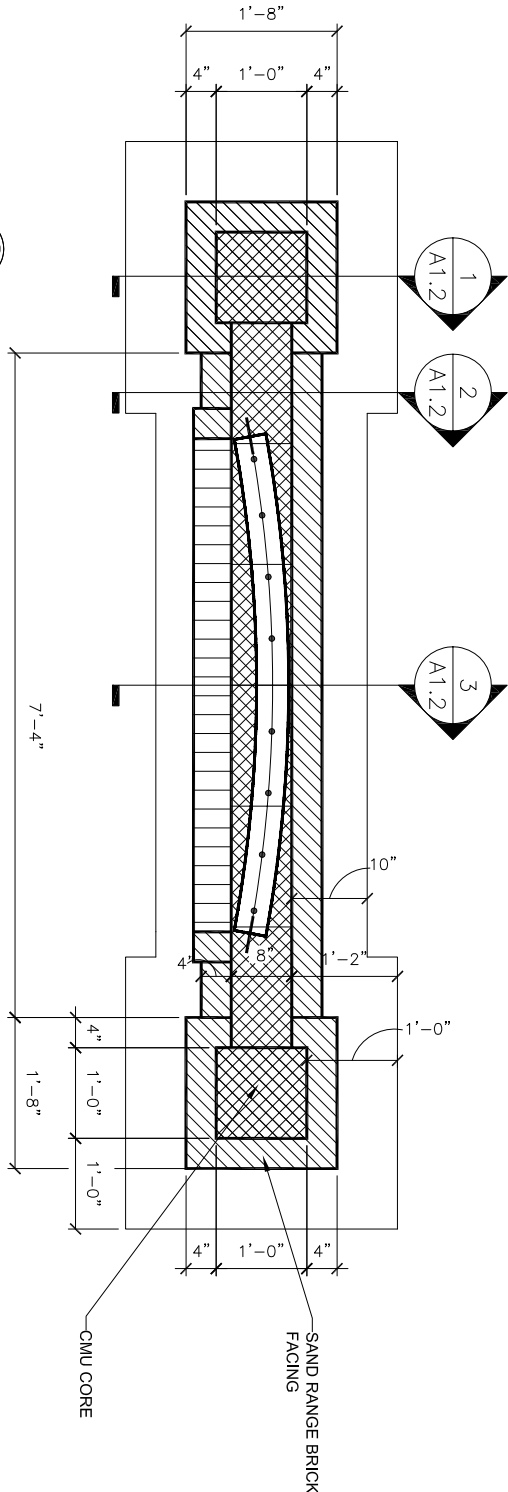

3
A1.1
Plan View
Scale: 1" - 1'-0"

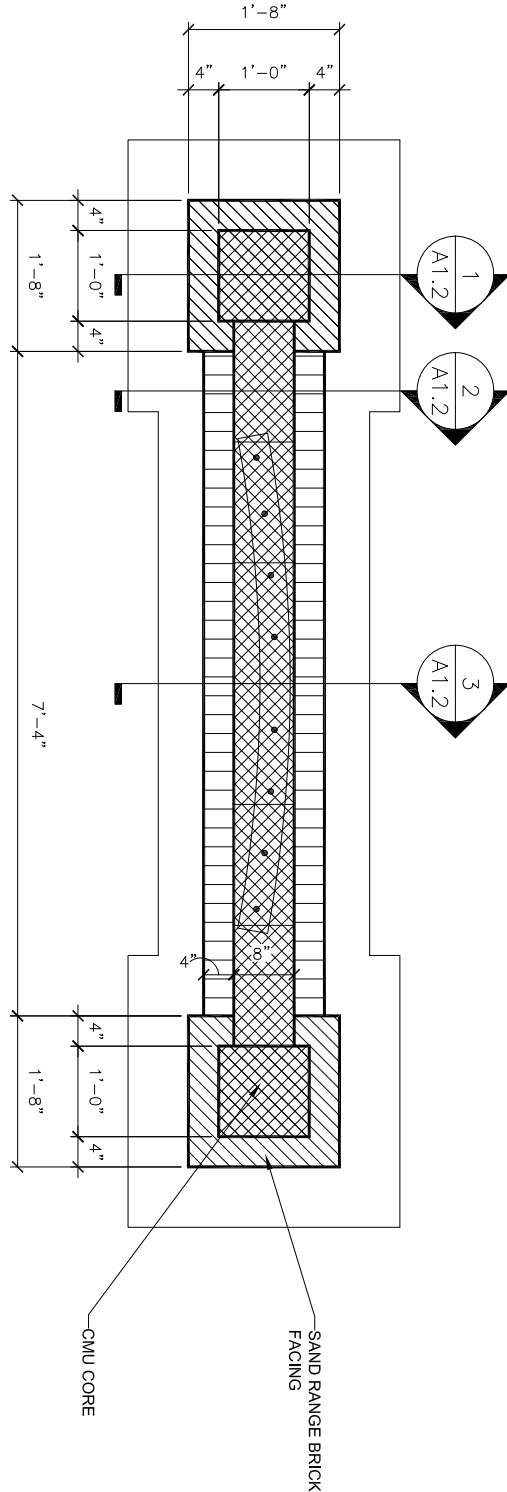

1
A1.1
Plan Views
Scale: 1" - 1'-0"

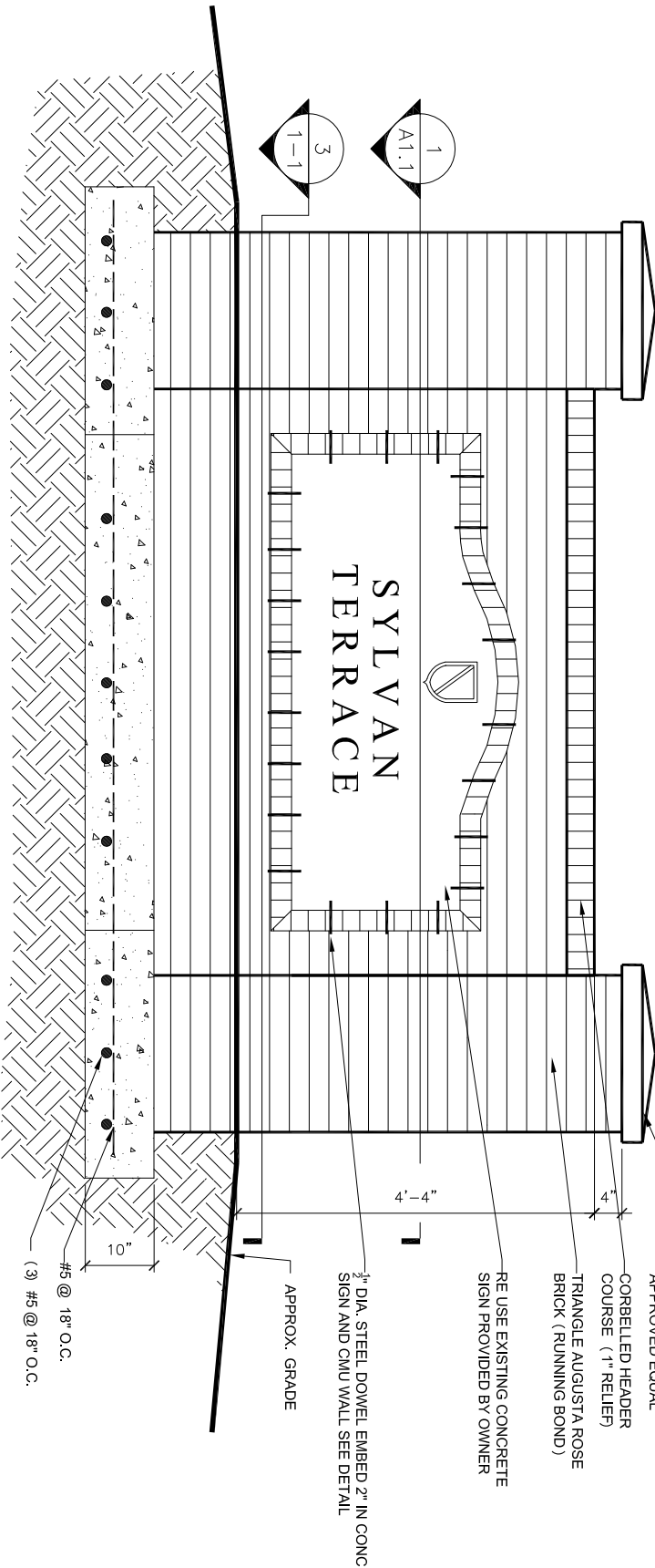

2
A1.1
Front Elevation
Scale: 1" - 1'-0"

Notes: Plans will need to be verified by a structural engineer.

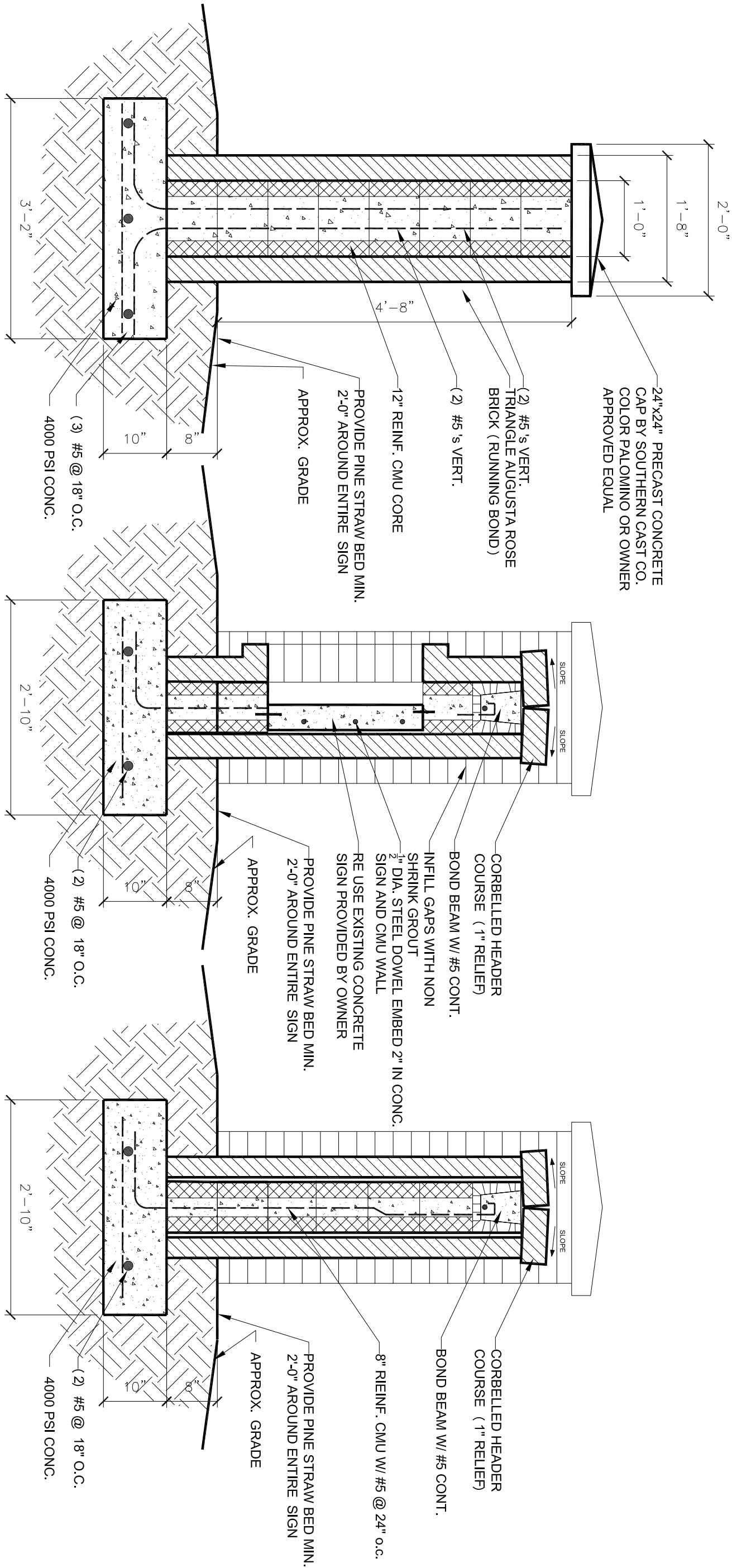

1 Section
A1.2 Scale: 1 1/2" = 1'-0"

2 Section
A1.2 Scale: 1 1/2" = 1'-0"

3 Section
A1.2 Scale: 1 1/2" = 1'-0"