



AERIAL MAP

File: 22-003056-ZA
Address: 1712 Oggeechee Rd.
Savannah, Ga
Aldermanic District: 1 - Lanier
Commission District: 3 - Lockett
Neighborhood: See Map
Property ID: See Map

Date: 7/5/2022



CHATHAM COUNTY - SAVANNAH
METROPOLITAN PLANNING COMMISSION
110 E. STATE ST. SAVANNAH, GA 31412-8248 PHONE 912-651-1440

THIS MAP IS A COMPILATION OF INFORMATION FROM VARIOUS SOURCES AND SCALES. IN MOST CASES THE INFORMATION HAS NOT BEEN FIELD VERIFIED. USE THIS MAP FOR GENERAL PLANNING PURPOSES ONLY.



1 inch = 50 feet

FUTURE LAND USE

File: 22-003056-ZA
 Address: 1712 Ogeechee Rd.
 Savannah, Ga
 Aldermanic District: 1 - Lanier
 Commission District: 3 - Lockett
 Neighborhood: See Map
 Property ID: See Map

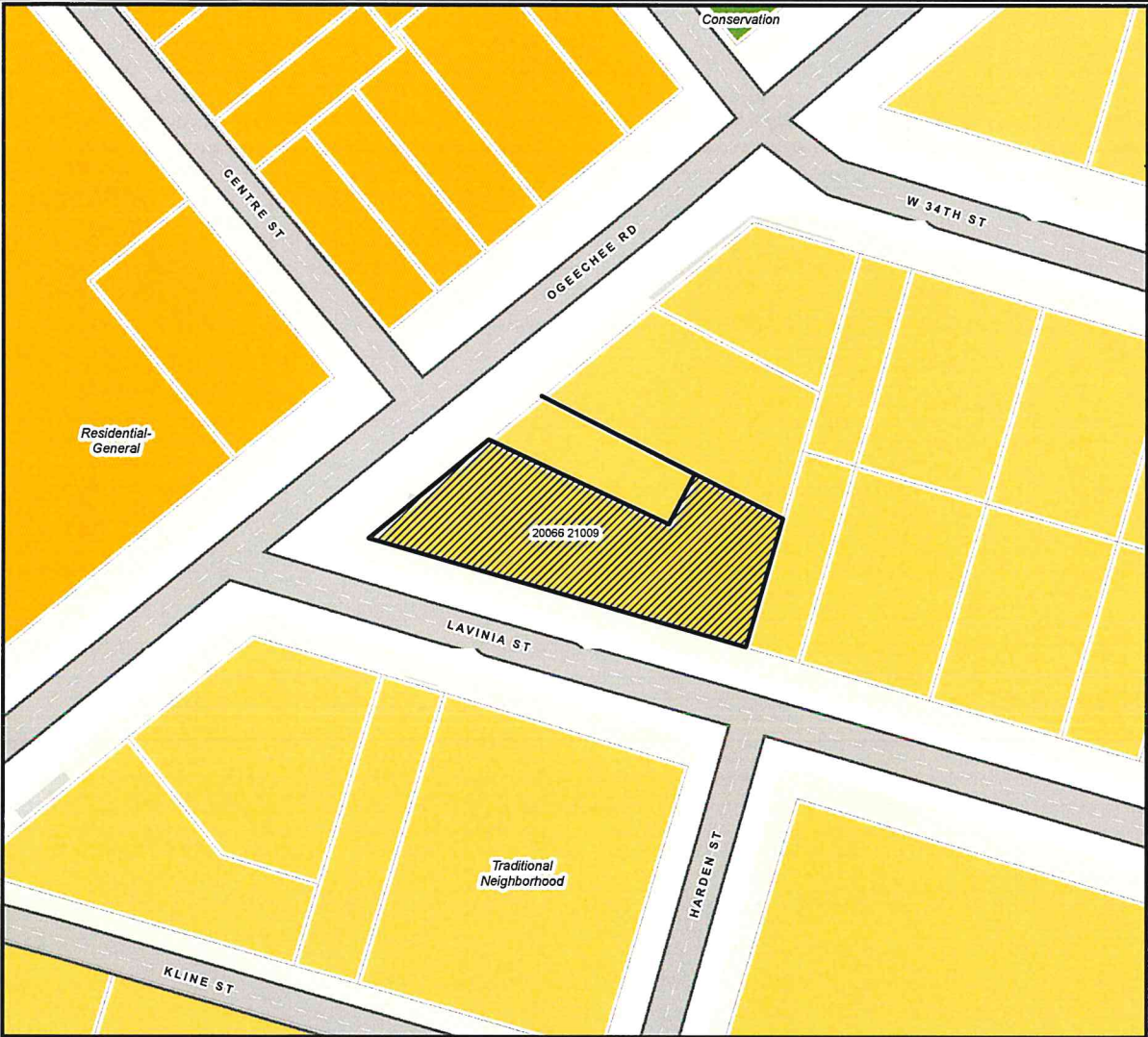

- Traditional Neighborhood
- Residential- General
- Conservation

Date: 7/5/2022



CHATHAM COUNTY - SAVANNAH
METROPOLITAN PLANNING COMMISSION
 110 E. STATE ST. SAVANNAH, GA 31412-9249 PHONE 912-651-1440

THIS MAP IS A COMPILATION OF INFORMATION FROM VARIOUS SOURCES AND SCALES. IN MOST CASES THE INFORMATION HAS NOT BEEN FIELD VERIFIED. USE THIS MAP FOR GENERAL PLANNING PURPOSES ONLY.



1 inch = 50 feet

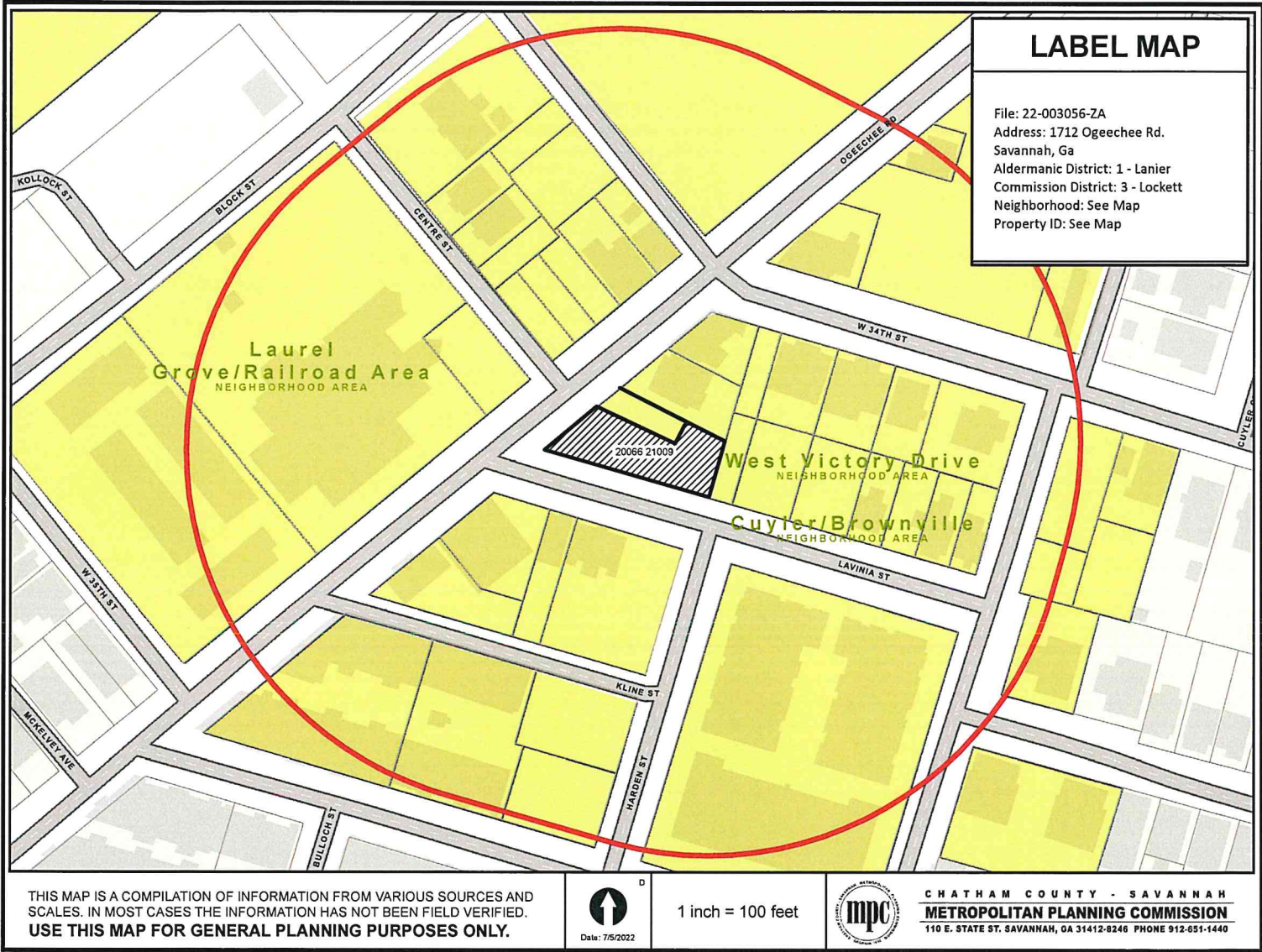

LABEL MAP

File: 22-003056-ZA
 Address: 1712 Ogeechee Rd.
 Savannah, Ga
 Aldermanic District: 1 - Lanier
 Commission District: 3 - Lockett
 Neighborhood: See Map
 Property ID: See Map

Laurel
Grove/Railroad Area
NEIGHBORHOOD AREA

West Victory Drive
NEIGHBORHOOD AREA

Cuyler/Brownville
NEIGHBORHOOD AREA

20066 21009

THIS MAP IS A COMPILATION OF INFORMATION FROM VARIOUS SOURCES AND SCALES. IN MOST CASES THE INFORMATION HAS NOT BEEN FIELD VERIFIED.
USE THIS MAP FOR GENERAL PLANNING PURPOSES ONLY.



1 inch = 100 feet



CHATHAM COUNTY - SAVANNAH
METROPOLITAN PLANNING COMMISSION
 110 E. STATE ST. SAVANNAH, GA 31412-8246 PHONE 912-651-1440

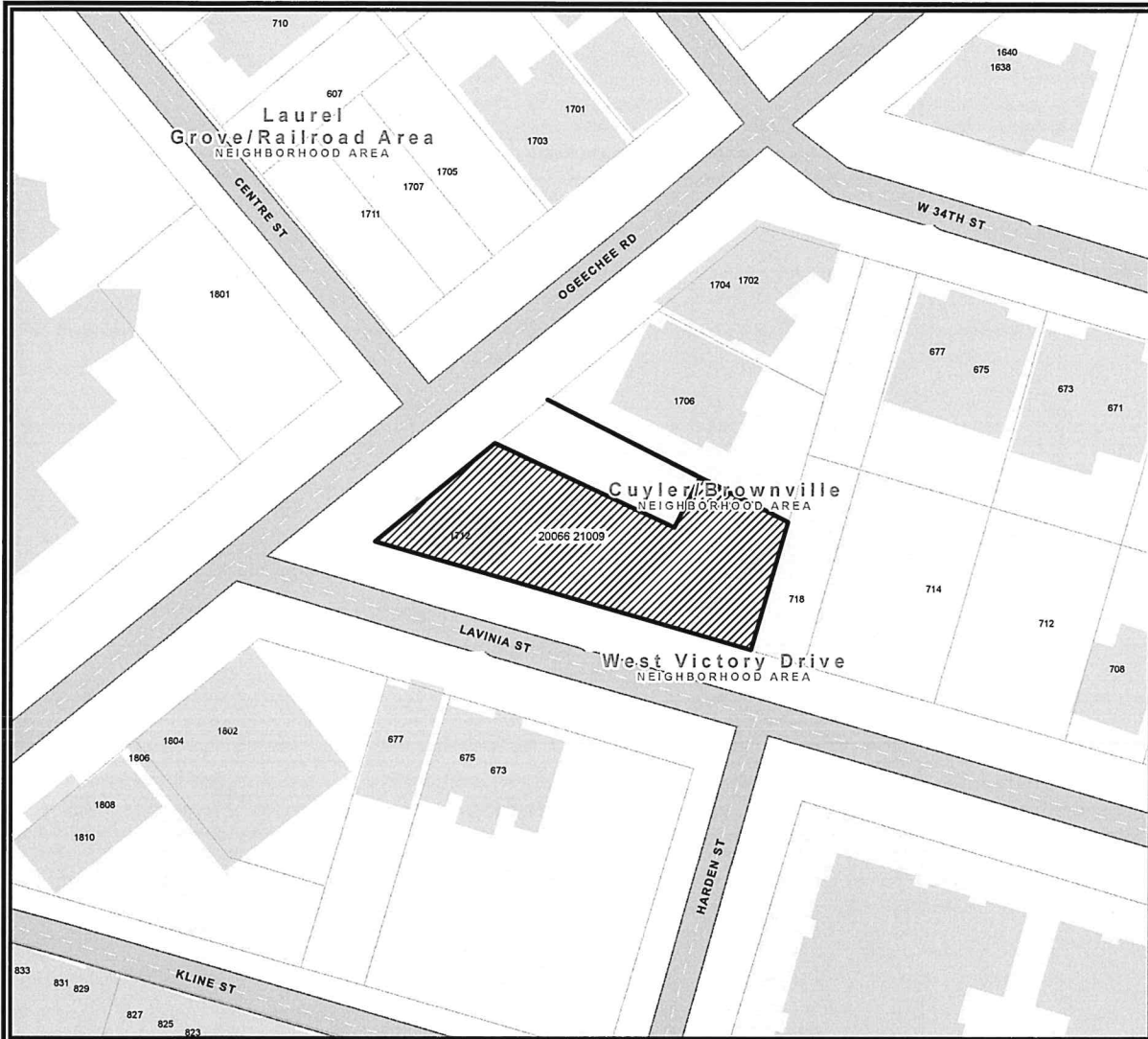

TAX MAP

File: 22-003056-ZA
 Address: 1712 Ogeechee Rd.
 Savannah, Ga
 Aldermanic District: 1 - Lanier
 Commission District: 3 - Lockett
 Neighborhood: See Map
 Property ID: See Map

Date: 7/5/2022



CHATHAM COUNTY - SAVANNAH
 METROPOLITAN PLANNING COMMISSION
 110 E. STATE ST. SAVANNAH, GA 31412-8248 PHONE 912-651-1440

THIS MAP IS A COMPILATION OF INFORMATION FROM VARIOUS SOURCES AND SCALES. IN MOST CASES THE INFORMATION HAS NOT BEEN FIELD VERIFIED. USE THIS MAP FOR GENERAL PLANNING PURPOSES ONLY.



1 inch = 50 feet

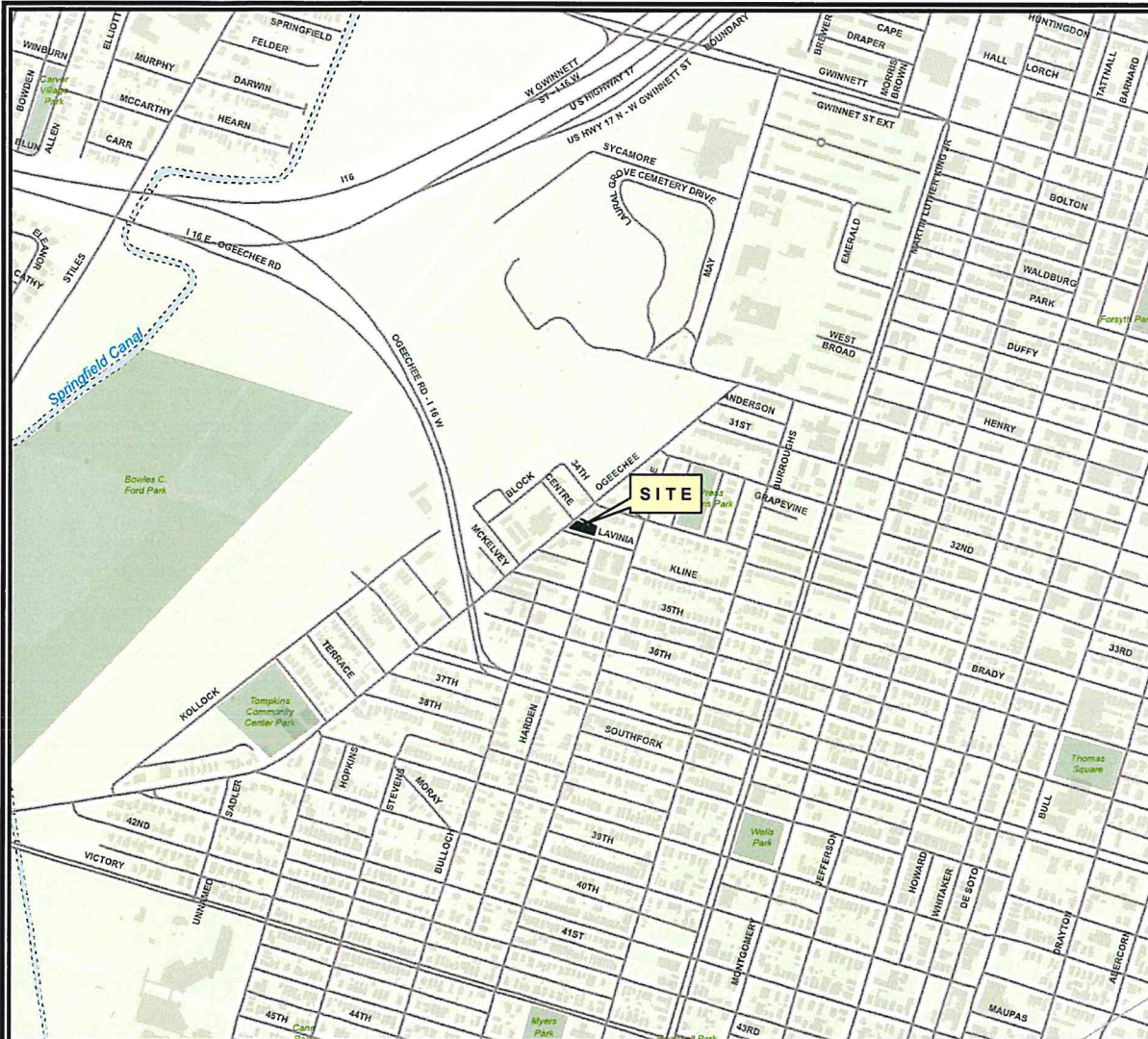

VICINITY MAP

File: 22-003056-ZA
 Address: 1712 Ogeechee Rd.
 Savannah, Ga
 Aldermanic District: 1 - Lanier
 Commission District: 3 - Lockett
 Neighborhood: See Map
 Property ID: See Map

THIS MAP IS A COMPILATION OF INFORMATION FROM VARIOUS SOURCES AND SCALES. IN MOST CASES THE INFORMATION HAS NOT BEEN FIELD VERIFIED. USE THIS MAP FOR GENERAL PLANNING PURPOSES ONLY.



1 inch = 800 feet



Date: 7/5/2022

CHATHAM COUNTY - SAVANNAH
METROPOLITAN PLANNING COMMISSION
 110 E. STATE ST. SAVANNAH, GA 31412-8246 PHONE 912-651-1445

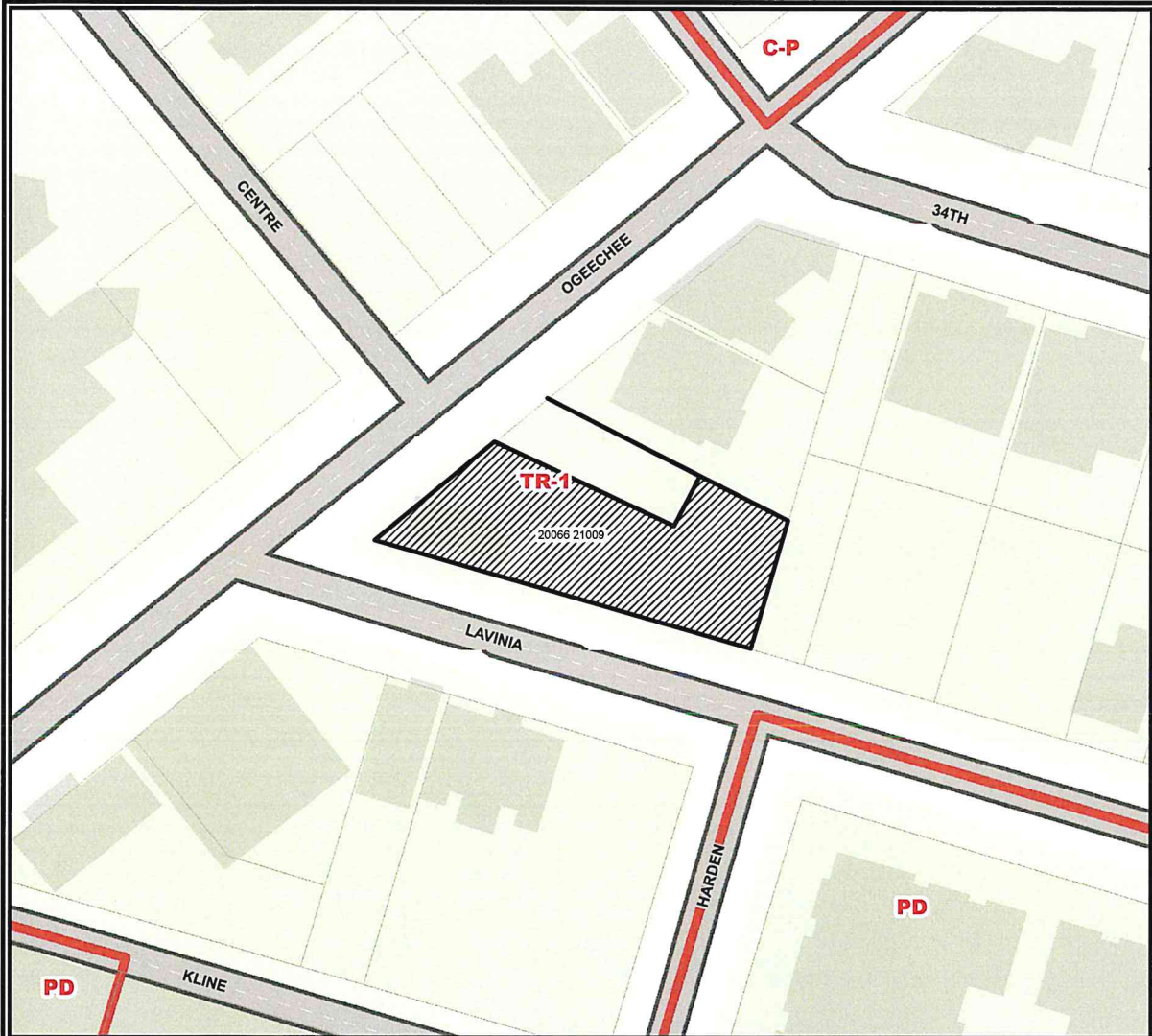

ZONING MAP

File: 22-003056-ZA
 Address: 1712 Ogeechee Rd.
 Savannah, Ga
 Aldermanic District: 1 - Lanier
 Commission District: 3 - Lockett
 Neighborhood: See Map
 Property ID: See Map

Current Property Zoning
 is Primarily
 TR-1
 Proposed Property Zoning:
 TC-1

 ZONING

Date: 7/5/2022



CHATHAM COUNTY - SAVANNAH
METROPOLITAN PLANNING COMMISSION
 110 E. STATE ST., SAVANNAH, GA 31412-8248 PHONE 912-451-1445

THIS MAP IS A COMPILATION OF INFORMATION FROM VARIOUS SOURCES AND SCALES. IN MOST CASES THE INFORMATION HAS NOT BEEN FIELD VERIFIED. USE THIS MAP FOR GENERAL PLANNING PURPOSES ONLY.



1 inch = 50 feet