

Rockingham Farms, LLC
2702 Whatley Avenue, Suite B-1
Savannah, Georgia 31404
Phone: (912) 925-3440 • Fax: (912) 925-9922

RECEIVED
CLERK OF COUNCIL OFFICE
NOV 20 2019
190480

September 13, 2019

Mr. Pat Monahan
City of Savannah, GA
2 East Bay Street
Savannah, GA 31402

RECEIVED
SEP 23 2019
City Manager's Office

RE: ANNEXATION PETITION OF ROCKINGHAM FARMS

Dear Mr. Monahan,

Enclosed please find a proposed Request for Annexation submitted by Rockingham Farms, LLC, the owner of property located on both sides of Veterans Parkway and generally lying between Buckhalter Road, Salt Creek and The Little Ogeechee River. We would request that the Request for Annexation be considered by City Council as soon as possible, and that it make the required determination that the annexation is in the best interests of the City of Savannah and the property owner.

Thank You,

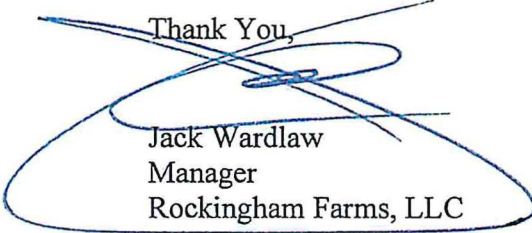
Jack Wardlaw
Manager
Rockingham Farms, LLC

September 13, 2019

Dear Mayor and Alderman of the City of Savannah, Georgia:

The undersigned, being the owner of the real property of the territory described herein, respectfully requests that the City Council of the City of Savannah annex this territory into the City of Savannah, Georgia, and extend the City boundaries to include the same.

The territory to be annexed is unincorporated and is or will be contiguous (as described in O.C.G.A. § 36-36-20) to the existing corporate limits of the City of Savannah, Georgia and the description of the parcel of the territory is attached hereto as Exhibit A and by this reference made a part hereof.

The attached Exhibit B shows the territory to be annexed.

For more information, please contact our attorney for this matter, Mr. Phillip McCorkle. Mr. McCorkle can be reached at (912) 233-6000, with a mailing address of 319 Tattnall St, Savannah, GA 31401.

Sincerely,

Jack Wardlaw

NOV 20 2019

190480

Exhibit A

A portion of Tax Parcel I.D. No. 1-0943-01-001 shown on a plat titled "A Plat of 954.86 Acre and a 81.83 Acre, Portion of Rockingham Farms, 7th G.M. District, Chatham County, State of Georgia" prepared for Rockingham Farms, LLC and dated 11/18/2019 by Coleman Company. Parcels to be annexed are shown on the plat as 954.86 acres and 81.83 acres, respectively, for a total of 1,036.69 acres to be annexed into the City of Savannah.

These two parcels being further described as:

954.86 ACRE PARCEL - ALL THAT CERTAIN TRACT OF LAND KNOWN AS a 954.86 ACRE PORTION OF ROCKINGHAM FARM, 7TH G.M. DISTRICT, CHATHAM COUNTY, GEORGIA, AND BEING MORE PARTICULARLY DESCRIBED AS FOLLOWS:

BEGINNING AT A CONCRETE MONUMENT LOCATED AT THE INTERSECTION OF THE SOUTHERN RIGHT-OF-WAY LINE OF OLD BUCKHALTER AND THE WESTERN RIGHT-OF-WAY LINE OF SOUTHWEST BYPASS AND CONTINUING ALONG THE RIGHT-OF-WAY LINE OF SOUTHWEST BYPASS TO FOLLOWING COURSES AND DISTANCES, S26°32'20"W A DISTANCE OF 404.47' TO A RWCMF (RIGHT-OF-WAY CONCRETE MONUMENT FOUND), S30°36'09"W A DISTANCE OF 284.55' TO A RWCMF, S35°02'16"W A DISTANCE OF 470.41' TO A RWCMF, S76°59'36"W A DISTANCE OF 66.10' TO A RWCMF, N67°49'57"W A DISTANCE OF 250.00' TO A POINT, S22°10'03"W, A DISTANCE OF 150.00' TO A POINT, S67°49'57"E, A DISTANCE OF 250.00' TO A POINT, S26°18'50"E A DISTANCE OF 68.90' TO A POINT, S11°27'20"W, A DISTANCE OF 747.95' TO A RWCMF, S18°49'52"W, A DISTANCE OF 140.11' TO A RWCMF, ALONG A CURVE TO THE RIGHT HAVING AN ARC DISTANCE OF 952.33', A RADIUS OF 2727.29', A DELTA OF 20°00'25", A TANGENT OF 481.06', A CHORD BEARING OF S32°24'34"W AND A CHORD DISTANCE OF 947.50' TO A RWCMF, S47°25'26"W A DISTANCE OF 575.92' TO A RWCMF, ALONG A CURVE TO THE RIGHT HAVING AN ARC DISTANCE OF 92.11', A RADIUS OF 2727.29', A DELTA OF 1°56'06", A TANGENT OF 46.06', A CHORD BEARING OF S56°51'08"W AND A CHORD DISTANCE OF 92.10' TO A RWCMF, S57°48'24"W A DISTANCE OF 1285.88' TO A CMF (CONCRETE MONUMENT FOUND); THENCE ALONG THE PROPERTY LINE OF TRACT 3, NOW OR FORMERLY BOARD OF EDUCATION THE FOLLOWING COURESES AND DISTANCES, N32°11'49"W A DISTANCE OF 1000.00' TO A CMF, S57°48'11"W A DISTANCE OF 706.05' TO A CMF, S32°11'49"E A DISTANCE OF 208.71' TO A CMF, S57°48'11"W A DISTANCE OF 208.71' TO A POINT, S32°11'49"E A DISTANCE OF 791.29' TO A CMF; THENCE ALONG THE RIGHT-OF-WAY OF SOUTHWEST BYPASS THE FOLLOWING COURSES AND DISTANCES, S57°48'24"W A DISTANCE OF 4100.82' TO A RWCMF, S62°12'42"W A DISTANCE

OF 1041.59' TO A POINT, S58°07'04"W A DISTANCE OF 344.21' TO A POINT, S47°47'27"W A DISTANCE OF 278.67' TO A POINT, ALONG A CURVE TO THE LEFT HAVING AN ARC DISTANCE OF 352.78', A RADIUS OF 2134.86', A DELTA OF 09°28'05", A TANGENT OF 176.79', A CHORD BEARING OF S36°13'48"W AND A CHORD DISTANCE OF 352.38' TO A POINT; THENCE ALONG THE EASTERN EDGE OF LITTLE OGEECHEE RIVER AND SALT CREEK THE FOLLOWING COURSES AND DISTANCES, N56°35'31"W A DISTANCE OF 896.98' TO A POINT, N35°24'39"E A DISTANCE OF 1604.67' TO A POINT, N28°06'33"E A DISTANCE OF 1154.78' TO A POINT, N09°44'37"W A DISTANCE OF 1342.23' TO A POINT, N11°49'20"E A DISTANCE OF 2093.69' TO A POINT; THENCE ALONG THE EASTERN RIGHT-OF-WAY LINE OF SEABOARD COASTLINE RAILROAD, N47°50'09"E, A DISTANCE OF 5686.95' TO AN IRF (IRON ROD FOUND); THENCE ALONG THE PROPERTY LINE OF NOW OR FORMERLY COASTAL EMPIRE MONTESSORI COMMUNITY ORGANIZATION, INC. THE FOLLOWING COURSES AND DISTANCES, S55°32'39"E A DISTANCE OF 575.61' TO A POINT, N34°21'09"E A DISTANCE OF 872.43' TO A PK NAIL FOUND; THENCE ALONG THE SOUTHERN RIGHT-OF-WAY LINE OF BUCKHALTER ROAD, S70°20'15"E A DISTANCE OF 105.10' TO A IRF AND CMF; THENCE ALONG THE WESTERN AND SOUTHERN PROPERTY LINE OF THE BURHAM TRACT THE FOLLOWING COURSES AND DISTANCES, S28°20'09"W A DISTANCE OF 1629.98' TO A CMF, S73°52'21"E A DISTANCE OF 1690.20' TO A CMF; THENCE ALONG THE WESTERN RIGHT-OF-WAY LINE OF BUCKHALTER ROAD EXTENTION, S24°11'34"W A DISTANCE OF 50.86' TO A CMF; THENCE ALONG THE SOUTHERN RIGHT-OF-WAY LINE OF OLD BUCKHALTER ROAD, S71°28'13"E A DISTANCE OF 1914.31' TO THE POINT OF BEGINNING; AND CONTAINING 954.86 ACRES OR 41,593,571 SQUARE FEET.

81.83 ACRE PARCEL - ALL THAT CERTAIN TRACT OF LAND KNOWN AS AN 81.83 ACRE PORTION OF ROCKINGHAM FARM, 7TH G.M. DISTRICT, CHATHAM COUNTY, GEORGIA, AND BEING MORE PARTICULARLY DESCRIBED AS FOLLOWS:

BEGINNING AT A POINT LOCATED AT THE INTERSECTION OF THE SOUTHERN RIGHT-OF-WAY LINE OF OLD BUCKHALTER AND THE EASTERN RIGHT-OF-WAY LINE OF SOUTHWEST BYPASS AND CONTINUING ALONG THE RIGHT-OF-WAY LINE OF OLD BUCKHALTER ROAD, S71°24'42"E A DISTANCE OF 520.66' TO A CMF; THENCE ALONG THE PROPERTY LINES OF NOW OR FORMERLY APRIL DIANA GRIFFIN THE FOLLOWING COURSES AND DISTANCES, S17°32'08"W A DISTANCE OF 573.63' TO A CMF, S53°29'27"E A DISTANCE OF 194.97' TO A CMF, S48°40'28"E A DISTANCE OF 26.57' TO A IPF, S55°24'36"W A DISTANCE OF 187.15' TO A CMF, S68°12'45"E A DISTANCE OF 220.38' TO A CMF, S62°20'05"E A DISTANCE OF 336.84' TO A POINT, S16°28'16"W A DISTANCE OF 337.39' TO A POINT, S28°41'56"E A DISTANCE OF 502.85' TO A IPF; THENCE ALONG THE WESTERN RIGHT-OF-WAY LINE OF SEABOARD COASTLINE RAILROAD THE FOLLOWING COURSES AND DISTANCES, S57°40'48"W A DISTANCE OF 850.00'

TO A POINT, S24°43'32"E A DISTANCE OF 75.66' TO A POINT, S57°40'48"W A DISTANCE OF 2435.89' TO A POINT; THENCE ALONG A WETLAND LINES BEING THE EASTERN PROPERTY LINE OF NOW OR FORMERLY VC MITCHELL THE FOLLOWING COURSES AND DISTANCES, N18°50'05"W A DISTANCE OF 86.38' TO A POINT, N16°52'43"E A DISTANCE OF 61.61' TO A POINT, N07°13'23"E A DISTANCE OF 78.79' TO A POINT, N15°36'19"E A DISTANCE OF 116.76' TO A POINT, N42°58'19"W A DISTANCE OF 80.02' TO A POINT, N19°48'35"W A DISTANCE OF 132.02' TO A POINT; THENCE ALONG THE EASTERN RIGHT-OF-WAY LINE OF SOUTHWEST BYPASS THE FOLLOWING COURSES AND DISTANCES, ALONG A CURVE TO THE LEFT HAVING AN ARC DISTANCE OF 894.73', A RADIUS OF 2964.79', A DELTA OF 17°17'28", A TANGENT OF 450.79', A CHORD BEARING OF N44°32'37"E AND A CHORD DISTANCE OF 891.34' TO A RWCMF(RIGHT-OF-WAY CONCRETE MONUMENT FOUND), N36°41'41"E A DISTANCE OF 417.53' TO A RWCMF, N28°20'48"E A DISTANCE OF 490.03' TO A RWCMF, N31°20'52"E A DISTANCE OF 221.41' TO A RWCMF, N34°47'50"E A DISTANCE OF 385.15' TO A POINT, N67°49'02"E A DISTANCE OF 80.71' TO A POINT, S67°49'57"E A DISTANCE OF 250.00' TO A POINT, N22°10'03"E A DISTANCE OF 150.00' TO A POINT, N67°49'57"W A DISTANCE OF 250.00' TO A POINT, N13°15'55"W A DISTANCE OF 105.42' TO A POINT, N10°44'08"E A DISTANCE OF 596.36' TO A RWCMF, N15°52'43"E A DISTANCE OF 329.86' TO A RWCMF, N20°46'49"E A DISTANCE OF 197.96' TO THE POINT OF BEGINNING; AND CONTAINING 81.83 ACRES OR 3,564,527 SQUARE FEET.

Exhibit B

Map No. 11
 Prepared by Coleman Company
 Chatham County, Georgia
 Approved by the Board of Commissioners
 BK 52 PG. 227

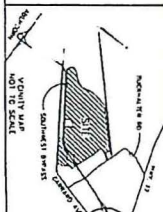

- LEGEND**
- 1. 20' WIDE RIGHT OF WAY
 - 2. 10' WIDE RIGHT OF WAY
 - 3. 5' WIDE RIGHT OF WAY
 - 4. 10' WIDE DRIVEWAY
 - 5. 5' WIDE DRIVEWAY
 - 6. 10' WIDE SIDEWALK
 - 7. 5' WIDE SIDEWALK
 - 8. 10' WIDE BIKEWAY
 - 9. 5' WIDE BIKEWAY
 - 10. 10' WIDE TRAIL
 - 11. 5' WIDE TRAIL
 - 12. 10' WIDE FENCE
 - 13. 5' WIDE FENCE
 - 14. 10' WIDE BARRIER
 - 15. 5' WIDE BARRIER
 - 16. 10' WIDE SIGN
 - 17. 5' WIDE SIGN
 - 18. 10' WIDE LIGHT
 - 19. 5' WIDE LIGHT
 - 20. 10' WIDE UTILITY
 - 21. 5' WIDE UTILITY
 - 22. 10' WIDE TELEPHONE
 - 23. 5' WIDE TELEPHONE
 - 24. 10' WIDE CABLE
 - 25. 5' WIDE CABLE
 - 26. 10' WIDE POWER
 - 27. 5' WIDE POWER
 - 28. 10' WIDE GAS
 - 29. 5' WIDE GAS
 - 30. 10' WIDE WATER
 - 31. 5' WIDE WATER
 - 32. 10' WIDE SEWER
 - 33. 5' WIDE SEWER
 - 34. 10' WIDE SANITARY
 - 35. 5' WIDE SANITARY
 - 36. 10' WIDE RAIN
 - 37. 5' WIDE RAIN
 - 38. 10' WIDE DRAIN
 - 39. 5' WIDE DRAIN
 - 40. 10' WIDE ERECTION
 - 41. 5' WIDE ERECTION
 - 42. 10' WIDE FOUNDATION
 - 43. 5' WIDE FOUNDATION
 - 44. 10' WIDE ROOF
 - 45. 5' WIDE ROOF
 - 46. 10' WIDE WALL
 - 47. 5' WIDE WALL
 - 48. 10' WIDE FLOOR
 - 49. 5' WIDE FLOOR
 - 50. 10' WIDE CEILING
 - 51. 5' WIDE CEILING
 - 52. 10' WIDE DOOR
 - 53. 5' WIDE DOOR
 - 54. 10' WIDE WINDOW
 - 55. 5' WIDE WINDOW
 - 56. 10' WIDE PORCH
 - 57. 5' WIDE PORCH
 - 58. 10' WIDE PATIO
 - 59. 5' WIDE PATIO
 - 60. 10' WIDE DECK
 - 61. 5' WIDE DECK
 - 62. 10' WIDE BALCONY
 - 63. 5' WIDE BALCONY
 - 64. 10' WIDE TERRACE
 - 65. 5' WIDE TERRACE
 - 66. 10' WIDE STAIR
 - 67. 5' WIDE STAIR
 - 68. 10' WIDE RAMP
 - 69. 5' WIDE RAMP
 - 70. 10' WIDE ELEVATOR
 - 71. 5' WIDE ELEVATOR
 - 72. 10' WIDE ESCALATOR
 - 73. 5' WIDE ESCALATOR
 - 74. 10' WIDE MECHANICAL
 - 75. 5' WIDE MECHANICAL
 - 76. 10' WIDE ELECTRICAL
 - 77. 5' WIDE ELECTRICAL
 - 78. 10' WIDE TELEVISION
 - 79. 5' WIDE TELEVISION
 - 80. 10' WIDE ANTENNA
 - 81. 5' WIDE ANTENNA
 - 82. 10' WIDE SATELLITE
 - 83. 5' WIDE SATELLITE
 - 84. 10' WIDE FIBER
 - 85. 5' WIDE FIBER
 - 86. 10' WIDE COAXIAL
 - 87. 5' WIDE COAXIAL
 - 88. 10' WIDE CABLE TV
 - 89. 5' WIDE CABLE TV
 - 90. 10' WIDE PHONE
 - 91. 5' WIDE PHONE
 - 92. 10' WIDE INTERNET
 - 93. 5' WIDE INTERNET
 - 94. 10' WIDE SECURITY
 - 95. 5' WIDE SECURITY
 - 96. 10' WIDE ALARMS
 - 97. 5' WIDE ALARMS
 - 98. 10' WIDE CAMERAS
 - 99. 5' WIDE CAMERAS
 - 100. 10' WIDE ACCESS
 - 101. 5' WIDE ACCESS
 - 102. 10' WIDE EGRESS
 - 103. 5' WIDE EGRESS
 - 104. 10' WIDE EXIT
 - 105. 5' WIDE EXIT
 - 106. 10' WIDE ENTRANCE
 - 107. 5' WIDE ENTRANCE
 - 108. 10' WIDE RECEPTION
 - 109. 5' WIDE RECEPTION
 - 110. 10' WIDE LOBBY
 - 111. 5' WIDE LOBBY
 - 112. 10' WIDE OFFICE
 - 113. 5' WIDE OFFICE
 - 114. 10' WIDE CONFERENCE
 - 115. 5' WIDE CONFERENCE
 - 116. 10' WIDE BOARD
 - 117. 5' WIDE BOARD
 - 118. 10' WIDE MEETING
 - 119. 5' WIDE MEETING
 - 120. 10' WIDE BREAK
 - 121. 5' WIDE BREAK
 - 122. 10' WIDE REST
 - 123. 5' WIDE REST
 - 124. 10' WIDE BATH
 - 125. 5' WIDE BATH
 - 126. 10' WIDE TOILET
 - 127. 5' WIDE TOILET
 - 128. 10' WIDE SHOWER
 - 129. 5' WIDE SHOWER
 - 130. 10' WIDE KITCHEN
 - 131. 5' WIDE KITCHEN
 - 132. 10' WIDE DINING
 - 133. 5' WIDE DINING
 - 134. 10' WIDE BREAKFAST
 - 135. 5' WIDE BREAKFAST
 - 136. 10' WIDE LIVING
 - 137. 5' WIDE LIVING
 - 138. 10' WIDE FAMILY
 - 139. 5' WIDE FAMILY
 - 140. 10' WIDE REAR
 - 141. 5' WIDE REAR
 - 142. 10' WIDE FRONT
 - 143. 5' WIDE FRONT
 - 144. 10' WIDE PORCH
 - 145. 5' WIDE PORCH
 - 146. 10' WIDE PATIO
 - 147. 5' WIDE PATIO
 - 148. 10' WIDE DECK
 - 149. 5' WIDE DECK
 - 150. 10' WIDE BALCONY
 - 151. 5' WIDE BALCONY
 - 152. 10' WIDE TERRACE
 - 153. 5' WIDE TERRACE
 - 154. 10' WIDE STAIR
 - 155. 5' WIDE STAIR
 - 156. 10' WIDE RAMP
 - 157. 5' WIDE RAMP
 - 158. 10' WIDE ELEVATOR
 - 159. 5' WIDE ELEVATOR
 - 160. 10' WIDE ESCALATOR
 - 161. 5' WIDE ESCALATOR
 - 162. 10' WIDE MECHANICAL
 - 163. 5' WIDE MECHANICAL
 - 164. 10' WIDE ELECTRICAL
 - 165. 5' WIDE ELECTRICAL
 - 166. 10' WIDE TELEVISION
 - 167. 5' WIDE TELEVISION
 - 168. 10' WIDE ANTENNA
 - 169. 5' WIDE ANTENNA
 - 170. 10' WIDE SATELLITE
 - 171. 5' WIDE SATELLITE
 - 172. 10' WIDE FIBER
 - 173. 5' WIDE FIBER
 - 174. 10' WIDE COAXIAL
 - 175. 5' WIDE COAXIAL
 - 176. 10' WIDE CABLE TV
 - 177. 5' WIDE CABLE TV
 - 178. 10' WIDE PHONE
 - 179. 5' WIDE PHONE
 - 180. 10' WIDE INTERNET
 - 181. 5' WIDE INTERNET
 - 182. 10' WIDE SECURITY
 - 183. 5' WIDE SECURITY
 - 184. 10' WIDE ALARMS
 - 185. 5' WIDE ALARMS
 - 186. 10' WIDE CAMERAS
 - 187. 5' WIDE CAMERAS
 - 188. 10' WIDE ACCESS
 - 189. 5' WIDE ACCESS
 - 190. 10' WIDE EGRESS
 - 191. 5' WIDE EGRESS
 - 192. 10' WIDE EXIT
 - 193. 5' WIDE EXIT
 - 194. 10' WIDE ENTRANCE
 - 195. 5' WIDE ENTRANCE
 - 196. 10' WIDE RECEPTION
 - 197. 5' WIDE RECEPTION
 - 198. 10' WIDE LOBBY
 - 199. 5' WIDE LOBBY
 - 200. 10' WIDE OFFICE
 - 201. 5' WIDE OFFICE
 - 202. 10' WIDE CONFERENCE
 - 203. 5' WIDE CONFERENCE
 - 204. 10' WIDE BOARD
 - 205. 5' WIDE BOARD
 - 206. 10' WIDE MEETING
 - 207. 5' WIDE MEETING
 - 208. 10' WIDE BREAK
 - 209. 5' WIDE BREAK
 - 210. 10' WIDE REST
 - 211. 5' WIDE REST
 - 212. 10' WIDE BATH
 - 213. 5' WIDE BATH
 - 214. 10' WIDE TOILET
 - 215. 5' WIDE TOILET
 - 216. 10' WIDE SHOWER
 - 217. 5' WIDE SHOWER
 - 218. 10' WIDE KITCHEN
 - 219. 5' WIDE KITCHEN
 - 220. 10' WIDE DINING
 - 221. 5' WIDE DINING
 - 222. 10' WIDE BREAKFAST
 - 223. 5' WIDE BREAKFAST
 - 224. 10' WIDE LIVING
 - 225. 5' WIDE LIVING
 - 226. 10' WIDE FAMILY
 - 227. 5' WIDE FAMILY
 - 228. 10' WIDE REAR
 - 229. 5' WIDE REAR
 - 230. 10' WIDE FRONT
 - 231. 5' WIDE FRONT
 - 232. 10' WIDE PORCH
 - 233. 5' WIDE PORCH
 - 234. 10' WIDE PATIO
 - 235. 5' WIDE PATIO
 - 236. 10' WIDE DECK
 - 237. 5' WIDE DECK
 - 238. 10' WIDE BALCONY
 - 239. 5' WIDE BALCONY
 - 240. 10' WIDE TERRACE
 - 241. 5' WIDE TERRACE
 - 242. 10' WIDE STAIR
 - 243. 5' WIDE STAIR
 - 244. 10' WIDE RAMP
 - 245. 5' WIDE RAMP
 - 246. 10' WIDE ELEVATOR
 - 247. 5' WIDE ELEVATOR
 - 248. 10' WIDE ESCALATOR
 - 249. 5' WIDE ESCALATOR
 - 250. 10' WIDE MECHANICAL
 - 251. 5' WIDE MECHANICAL
 - 252. 10' WIDE ELECTRICAL
 - 253. 5' WIDE ELECTRICAL
 - 254. 10' WIDE TELEVISION
 - 255. 5' WIDE TELEVISION
 - 256. 10' WIDE ANTENNA
 - 257. 5' WIDE ANTENNA
 - 258. 10' WIDE SATELLITE
 - 259. 5' WIDE SATELLITE
 - 260. 10' WIDE FIBER
 - 261. 5' WIDE FIBER
 - 262. 10' WIDE COAXIAL
 - 263. 5' WIDE COAXIAL
 - 264. 10' WIDE CABLE TV
 - 265. 5' WIDE CABLE TV
 - 266. 10' WIDE PHONE
 - 267. 5' WIDE PHONE
 - 268. 10' WIDE INTERNET
 - 269. 5' WIDE INTERNET
 - 270. 10' WIDE SECURITY
 - 271. 5' WIDE SECURITY
 - 272. 10' WIDE ALARMS
 - 273. 5' WIDE ALARMS
 - 274. 10' WIDE CAMERAS
 - 275. 5' WIDE CAMERAS
 - 276. 10' WIDE ACCESS
 - 277. 5' WIDE ACCESS
 - 278. 10' WIDE EGRESS
 - 279. 5' WIDE EGRESS
 - 280. 10' WIDE EXIT
 - 281. 5' WIDE EXIT
 - 282. 10' WIDE ENTRANCE
 - 283. 5' WIDE ENTRANCE
 - 284. 10' WIDE RECEPTION
 - 285. 5' WIDE RECEPTION
 - 286. 10' WIDE LOBBY
 - 287. 5' WIDE LOBBY
 - 288. 10' WIDE OFFICE
 - 289. 5' WIDE OFFICE
 - 290. 10' WIDE CONFERENCE
 - 291. 5' WIDE CONFERENCE
 - 292. 10' WIDE BOARD
 - 293. 5' WIDE BOARD
 - 294. 10' WIDE MEETING
 - 295. 5' WIDE MEETING
 - 296. 10' WIDE BREAK
 - 297. 5' WIDE BREAK
 - 298. 10' WIDE REST
 - 299. 5' WIDE REST
 - 300. 10' WIDE BATH
 - 301. 5' WIDE BATH
 - 302. 10' WIDE TOILET
 - 303. 5' WIDE TOILET
 - 304. 10' WIDE SHOWER
 - 305. 5' WIDE SHOWER
 - 306. 10' WIDE KITCHEN
 - 307. 5' WIDE KITCHEN
 - 308. 10' WIDE DINING
 - 309. 5' WIDE DINING
 - 310. 10' WIDE BREAKFAST
 - 311. 5' WIDE BREAKFAST
 - 312. 10' WIDE LIVING
 - 313. 5' WIDE LIVING
 - 314. 10' WIDE FAMILY
 - 315. 5' WIDE FAMILY
 - 316. 10' WIDE REAR
 - 317. 5' WIDE REAR
 - 318. 10' WIDE FRONT
 - 319. 5' WIDE FRONT
 - 320. 10' WIDE PORCH
 - 321. 5' WIDE PORCH
 - 322. 10' WIDE PATIO
 - 323. 5' WIDE PATIO
 - 324. 10' WIDE DECK
 - 325. 5' WIDE DECK
 - 326. 10' WIDE BALCONY
 - 327. 5' WIDE BALCONY
 - 328. 10' WIDE TERRACE
 - 329. 5' WIDE TERRACE
 - 330. 10' WIDE STAIR
 - 331. 5' WIDE STAIR
 - 332. 10' WIDE RAMP
 - 333. 5' WIDE RAMP
 - 334. 10' WIDE ELEVATOR
 - 335. 5' WIDE ELEVATOR
 - 336. 10' WIDE ESCALATOR
 - 337. 5' WIDE ESCALATOR
 - 338. 10' WIDE MECHANICAL
 - 339. 5' WIDE MECHANICAL
 - 340. 10' WIDE ELECTRICAL
 - 341. 5' WIDE ELECTRICAL
 - 342. 10' WIDE TELEVISION
 - 343. 5' WIDE TELEVISION
 - 344. 10' WIDE ANTENNA
 - 345. 5' WIDE ANTENNA
 - 346. 10' WIDE SATELLITE
 - 347. 5' WIDE SATELLITE
 - 348. 10' WIDE FIBER
 - 349. 5' WIDE FIBER
 - 350. 10' WIDE COAXIAL
 - 351. 5' WIDE COAXIAL
 - 352. 10' WIDE CABLE TV
 - 353. 5' WIDE CABLE TV
 - 354. 10' WIDE PHONE
 - 355. 5' WIDE PHONE
 - 356. 10' WIDE INTERNET
 - 357. 5' WIDE INTERNET
 - 358. 10' WIDE SECURITY
 - 359. 5' WIDE SECURITY
 - 360. 10' WIDE ALARMS
 - 361. 5' WIDE ALARMS
 - 362. 10' WIDE CAMERAS
 - 363. 5' WIDE CAMERAS
 - 364. 10' WIDE ACCESS
 - 365. 5' WIDE ACCESS
 - 366. 10' WIDE EGRESS
 - 367. 5' WIDE EGRESS
 - 368. 10' WIDE EXIT
 - 369. 5' WIDE EXIT
 - 370. 10' WIDE ENTRANCE
 - 371. 5' WIDE ENTRANCE
 - 372. 10' WIDE RECEPTION
 - 373. 5' WIDE RECEPTION
 - 374. 10' WIDE LOBBY
 - 375. 5' WIDE LOBBY
 - 376. 10' WIDE OFFICE
 - 377. 5' WIDE OFFICE
 - 378. 10' WIDE CONFERENCE
 - 379. 5' WIDE CONFERENCE
 - 380. 10' WIDE BOARD
 - 381. 5' WIDE BOARD
 - 382. 10' WIDE MEETING
 - 383. 5' WIDE MEETING
 - 384. 10' WIDE BREAK
 - 385. 5' WIDE BREAK
 - 386. 10' WIDE REST
 - 387. 5' WIDE REST
 - 388. 10' WIDE BATH
 - 389. 5' WIDE BATH
 - 390. 10' WIDE TOILET
 - 391. 5' WIDE TOILET
 - 392. 10' WIDE SHOWER
 - 393. 5' WIDE SHOWER
 - 394. 10' WIDE KITCHEN
 - 395. 5' WIDE KITCHEN
 - 396. 10' WIDE DINING
 - 397. 5' WIDE DINING
 - 398. 10' WIDE BREAKFAST
 - 399. 5' WIDE BREAKFAST
 - 400. 10' WIDE LIVING
 - 401. 5' WIDE LIVING
 - 402. 10' WIDE FAMILY
 - 403. 5' WIDE FAMILY
 - 404. 10' WIDE REAR
 - 405. 5' WIDE REAR
 - 406. 10' WIDE FRONT
 - 407. 5' WIDE FRONT
 - 408. 10' WIDE PORCH
 - 409. 5' WIDE PORCH
 - 410. 10' WIDE PATIO
 - 411. 5' WIDE PATIO
 - 412. 10' WIDE DECK
 - 413. 5' WIDE DECK
 - 414. 10' WIDE BALCONY
 - 415. 5' WIDE BALCONY
 - 416. 10' WIDE TERRACE
 - 417. 5' WIDE TERRACE
 - 418. 10' WIDE STAIR
 - 419. 5' WIDE STAIR
 - 420. 10' WIDE RAMP
 - 421. 5' WIDE RAMP
 - 422. 10' WIDE ELEVATOR
 - 423. 5' WIDE ELEVATOR
 - 424. 10' WIDE ESCALATOR
 - 425. 5' WIDE ESCALATOR
 - 426. 10' WIDE MECHANICAL
 - 427. 5' WIDE MECHANICAL
 - 428. 10' WIDE ELECTRICAL
 - 429. 5' WIDE ELECTRICAL
 - 430. 10' WIDE TELEVISION
 - 431. 5' WIDE TELEVISION
 - 432. 10' WIDE ANTENNA
 - 433. 5' WIDE ANTENNA
 - 434. 10' WIDE SATELLITE
 - 435. 5' WIDE SATELLITE
 - 436. 10' WIDE FIBER
 - 437. 5' WIDE FIBER
 - 438. 10' WIDE COAXIAL
 - 439. 5' WIDE COAXIAL
 - 440. 10' WIDE CABLE TV
 - 441. 5' WIDE CABLE TV
 - 442. 10' WIDE PHONE
 - 443. 5' WIDE PHONE
 - 444. 10' WIDE INTERNET
 - 445. 5' WIDE INTERNET
 - 446. 10' WIDE SECURITY
 - 447. 5' WIDE SECURITY
 - 448. 10' WIDE ALARMS
 - 449. 5' WIDE ALARMS
 - 450. 10' WIDE CAMERAS
 - 451. 5' WIDE CAMERAS
 - 452. 10' WIDE ACCESS
 - 453. 5' WIDE ACCESS
 - 454. 10' WIDE EGRESS
 - 455. 5' WIDE EGRESS
 - 456. 10' WIDE EXIT
 - 457. 5' WIDE EXIT
 - 458. 10' WIDE ENTRANCE
 - 459. 5' WIDE ENTRANCE
 - 460. 10' WIDE RECEPTION
 - 461. 5' WIDE RECEPTION
 - 462. 10' WIDE LOBBY
 - 463. 5' WIDE LOBBY
 - 464. 10' WIDE OFFICE
 - 465. 5' WIDE OFFICE
 - 466. 10' WIDE CONFERENCE
 - 467. 5' WIDE CONFERENCE
 - 468. 10' WIDE BOARD
 - 469. 5' WIDE BOARD
 - 470. 10' WIDE MEETING
 - 471. 5' WIDE MEETING
 - 472. 10' WIDE BREAK
 - 473. 5' WIDE BREAK
 - 474. 10' WIDE REST
 - 475. 5' WIDE REST
 - 476. 10' WIDE BATH
 - 477. 5' WIDE BATH
 - 478. 10' WIDE TOILET
 - 479. 5' WIDE TOILET
 - 480. 10' WIDE SHOWER
 - 481. 5' WIDE SHOWER
 - 482. 10' WIDE KITCHEN
 - 483. 5' WIDE KITCHEN
 - 484. 10' WIDE DINING
 - 485. 5' WIDE DINING
 - 486. 10' WIDE BREAKFAST
 - 487. 5' WIDE BREAKFAST
 - 488. 10' WIDE LIVING
 - 489. 5' WIDE LIVING
 - 490. 10' WIDE FAMILY
 - 491. 5' WIDE FAMILY
 - 492. 10' WIDE REAR
 - 493. 5' WIDE REAR
 - 494. 10' WIDE FRONT
 - 495. 5' WIDE FRONT
 - 496. 10' WIDE PORCH
 - 497. 5' WIDE PORCH
 - 498. 10' WIDE PATIO
 - 499. 5' WIDE PATIO
 - 500. 10' WIDE DECK
 - 501. 5' WIDE DECK
 - 502. 10' WIDE BALCONY
 - 503. 5' WIDE BALCONY
 - 504. 10' WIDE TERRACE
 - 505. 5' WIDE TERRACE
 - 506. 10' WIDE STAIR
 - 507. 5' WIDE STAIR
 - 508. 10' WIDE RAMP
 - 509. 5' WIDE RAMP
 - 510. 10' WIDE ELEVATOR
 - 511. 5' WIDE ELEVATOR
 - 512. 10' WIDE ESCALATOR
 - 513. 5' WIDE ESCALATOR
 - 514. 10' WIDE MECHANICAL
 - 515. 5' WIDE MECHANICAL
 - 516. 10' WIDE ELECTRICAL
 - 517. 5' WIDE ELECTRICAL
 - 518. 10' WIDE TELEVISION
 - 519. 5' WIDE TELEVISION
 - 520. 10' WIDE ANTENNA
 - 521. 5' WIDE ANTENNA
 - 522. 10' WIDE SATELLITE
 - 523. 5' WIDE SATELLITE
 - 524. 10' WIDE FIBER
 - 525. 5' WIDE FIBER
 - 526. 10' WIDE COAXIAL
 - 527. 5' WIDE COAXIAL
 - 528. 10' WIDE CABLE TV
 - 529. 5' WIDE CABLE TV
 - 530. 10' WIDE PHONE
 - 531. 5' WIDE PHONE
 - 532. 10' WIDE INTERNET
 - 533. 5' WIDE INTERNET
 - 534. 10' WIDE SECURITY
 - 535. 5' WIDE SECURITY
 - 536. 10' WIDE ALARMS
 - 537. 5' WIDE ALARMS
 - 538. 10' WIDE CAMERAS
 - 539. 5' WIDE CAMERAS
 - 540. 10' WIDE ACCESS
 - 541. 5' WIDE ACCESS
 - 542. 10' WIDE EGRESS
 - 543. 5' WIDE EGRESS
 - 544. 10' WIDE EXIT
 - 545. 5' WIDE EXIT
 - 546. 10' WIDE ENTRANCE
 - 547. 5' WIDE ENTRANCE
 - 548. 10' WIDE RECEPTION
 - 549. 5' WIDE RECEPTION
 - 550. 10' WIDE LOBBY
 - 551. 5' WIDE LOBBY
 - 552. 10' WIDE OFFICE
 - 553. 5' WIDE OFFICE
 - 554. 10' WIDE CONFERENCE
 - 555. 5' WIDE CONFERENCE
 - 556. 10' WIDE BOARD
 - 557. 5' WIDE BOARD
 - 558. 10' WIDE MEETING
 - 559. 5' WIDE MEETING
 - 560. 10' WIDE BREAK
 - 561. 5' WIDE BREAK
 - 562. 10' WIDE REST
 - 563. 5' WIDE REST
 - 564. 10' WIDE BATH
 - 565. 5' WIDE BATH
 - 566. 10' WIDE TOILET
 - 567. 5' WIDE TOILET
 - 568. 10' WIDE SHOWER
 - 569. 5' WIDE SHOWER
 - 570. 10' WIDE KITCHEN
 - 571. 5' WIDE KITCHEN
 - 572. 10' WIDE DINING
 - 573. 5' WIDE DINING
 - 574. 10' WIDE BREAKFAST
 - 575. 5' WIDE BREAKFAST
 - 576. 10' WIDE LIVING
 - 577. 5' WIDE LIVING
 - 578. 10' WIDE FAMILY
 - 579. 5' WIDE FAMILY
 - 580. 10' WIDE REAR
 - 581. 5' WIDE REAR
 - 582. 10' WIDE FRONT
 - 583. 5' WIDE FRONT
 - 584. 10' WIDE PORCH
 - 585. 5' WIDE PORCH
 - 586. 10' WIDE PATIO
 - 587. 5' WIDE PATIO
 - 588. 10' WIDE DECK
 - 589. 5' WIDE DECK
 - 590. 10' WIDE BALCONY
 - 591. 5' WIDE BALCONY
 - 592. 10' WIDE TERRACE
 - 593. 5' WIDE TERRACE
 - 594. 10' WIDE STAIR
 - 595. 5' WIDE STAIR
 - 596. 10' WIDE RAMP
 - 597. 5' WIDE RAMP
 - 598. 10' WIDE ELEVATOR
 - 599. 5' WIDE ELEVATOR
 - 600. 10' WIDE ESCALATOR
 - 601. 5' WIDE ESCALATOR
 - 602. 10' WIDE MECHANICAL
 - 603. 5' WIDE MECHANICAL
 - 604. 10' WIDE ELECTRICAL
 - 605. 5' WIDE ELECTRICAL
 - 606. 10' WIDE TELEVISION
 - 607. 5' WIDE TELEVISION
 - 608. 10' WIDE ANTENNA
 - 609. 5' WIDE ANTENNA
 - 610. 10' WIDE SATELLITE
 - 611. 5' WIDE SATELLITE
 - 612. 10' WIDE FIBER
 - 613. 5' WIDE FIBER
 - 614. 10' WIDE COAXIAL
 - 615. 5' WIDE COAXIAL
 - 616. 10' WIDE CABLE TV
 - 617. 5' WIDE CABLE TV
 - 618. 10' WIDE PHONE
 - 619. 5' WIDE PHONE
 - 620. 10' WIDE INTERNET
 - 621. 5' WIDE INTERNET
 - 622. 10' WIDE SECURITY
 - 623. 5' WIDE SECURITY
 - 624. 10' WIDE ALARMS
 - 625. 5' WIDE ALARMS
 - 626. 10' WIDE CAMERAS
 - 627. 5' WIDE CAMERAS
 - 628. 10' WIDE ACCESS
 - 629. 5' WIDE ACCESS
 - 630. 10' WIDE EGRESS
 - 631. 5' WIDE EGRESS
 - 632. 10' WIDE EXIT
 - 633. 5' WIDE EXIT
 - 634. 10' WIDE ENTRANCE
 - 635. 5' WIDE ENTRANCE
 - 636. 10' WIDE RECEPTION
 - 637. 5' WIDE RECEPTION
 - 638. 10' WIDE LOBBY
 - 639. 5' WIDE LOBBY
 - 640. 10' WIDE OFFICE
 - 641. 5' WIDE OFFICE
 - 642. 10' WIDE CONFERENCE
 - 643. 5' WIDE CONFERENCE
 - 644. 10' WIDE BOARD
 - 645. 5' WIDE BOARD
 - 646. 10' WIDE MEETING
 - 647. 5' WIDE MEETING
 - 648. 10' WIDE BREAK
 - 649. 5' WIDE BREAK
 - 650. 10' WIDE REST
 - 651. 5' WIDE REST
 - 652. 10' WIDE BATH
 - 653. 5' WIDE BATH
 - 654. 10' WIDE TOILET
 - 655. 5' WIDE TOILET
 - 656. 10' WIDE SHOWER
 - 657. 5' WIDE SHOWER
 - 658. 10' WIDE KITCHEN
 - 659. 5' WIDE KITCHEN
 - 660. 10' WIDE DINING
 - 661. 5' WIDE DINING
 - 662. 10' WIDE BREAKFAST
 - 663. 5' WIDE BREAKFAST
 - 664. 10' WIDE LIVING
 - 665. 5' WIDE LIVING
 - 666. 10' WIDE FAMILY
 - 667. 5' WIDE FAMILY
 - 668. 10' WIDE REAR
 - 669. 5' WIDE REAR
 - 670. 10' WIDE FRONT
 - 671. 5' WIDE FRONT
 - 672. 10' WIDE PORCH
 - 673. 5' WIDE PORCH
 - 674. 10' WIDE PATIO
 - 675. 5' WIDE PATIO
 - 676. 10' WIDE DECK
 - 677. 5' WIDE DECK
 - 678. 10' WIDE BALCONY
 - 679. 5' WIDE BALCONY
 - 680. 10' WIDE TERRACE
 - 681. 5' WIDE TERRACE
 - 682. 10' WIDE STAIR
 - 683. 5' WIDE STAIR
 - 684. 10' WIDE RAMP
 - 685. 5' WIDE RAMP
 - 686. 10' WIDE ELEVATOR
 - 687. 5' WIDE ELEVATOR
 - 688. 10' WIDE ESCALATOR
 - 689. 5' WIDE ESCALATOR
 - 690. 10' WIDE MECHANICAL
 - 691. 5' WIDE MECHANICAL
 - 692. 10' WIDE ELECTRICAL
 - 693. 5' WIDE ELECTRICAL
 - 694. 10' WIDE TELEVISION
 - 695. 5'