

Notes:

EV # 138012

Dean Forest - Little Ogeechee 230 KV Line

Structure 35-41

1319 Dean Forest Rd.

25' wide easement

5' Access Encroachment for the installation of a 16" and additional future Water Main that size has not been determined for the City of Savannah. This will be placed outside of Georgia Power's ROW.

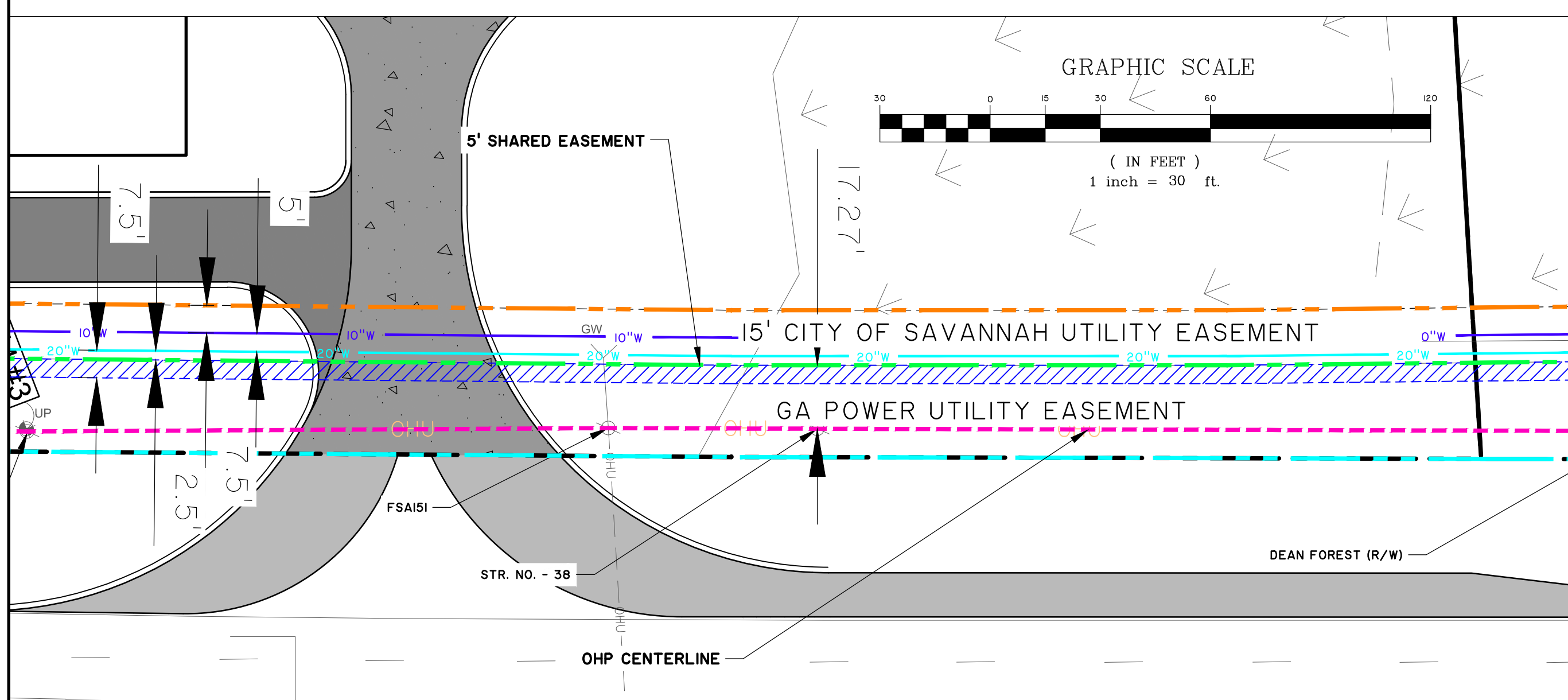
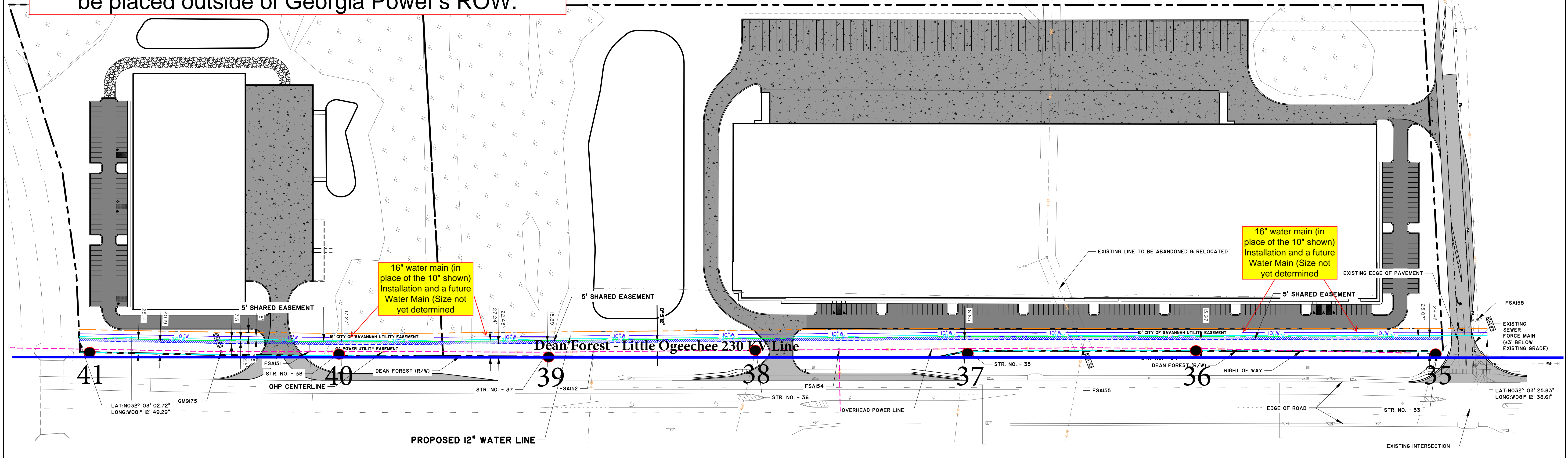
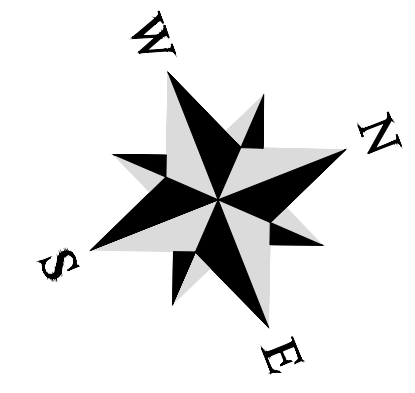
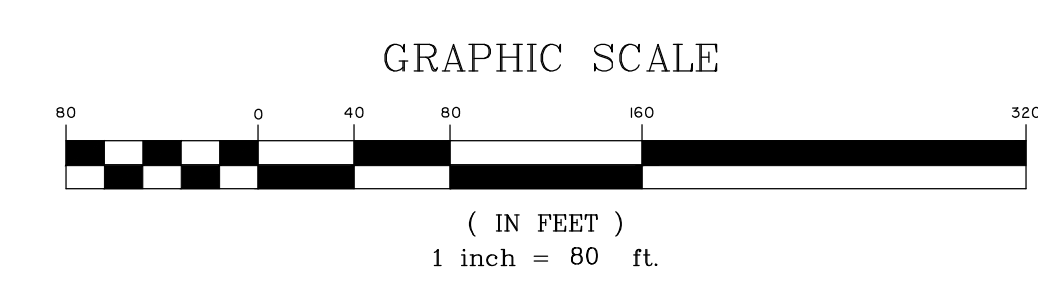

Exhibit A



SITE EXHIBIT
DEAN FOREST
 CITY OF SAVANNAH, GA
 PREPARED FOR:
 NORTH SIGNAL
 PREPARED BY:
THOMAS & HUTTON
 50 Park of Commerce Way
 Savannah, GA 31405 • 912.234.5300
 www.thomasandhutton.com

| | |
|-----------------|-----------------|
| JOB NO: J-27379 | DATE: 11/20/18 |
| DRAWN: DSG | SCALE: 1" = 80' |
| REVIEWED: JOC | SHEET: EX |