

2018 Chatham County Board of Assessors

2-0019-17-034

Property Record Card

218 CUMMING ST SAVANNAH

APPRAISER	EPORTER	LOT 56 MITCHELL WD BRODY PLACE	BLACK JOE	CAMA	ASMT		
LAST INSP	03/28/2018		15 ROBIN HOOD DR	3,000	3,000	LAND	1
APPR ZONE	000001		SAVANNAH GA 31406	6,300	6,300	BLDG	1
						OBXF	0
				9,300	9,300	Cost - MS	

SALES	BOOK / PAGE	INS VI QU RSN PRICE
03 Apr 2001	220Q 0151 NA I U UN	
GRANTOR:DUPREE JOHN A & ROSA L		
GRANTEE:BLACK JOE		



[Click for larger picture]

CODES		
PROPERTY USE	0006	RESIDENTIAL
UTA	0002	Savannah
NBHD	006024.00	F024 FELLWOOD LINCOLN
EXEMPTIONS		

PERMITS	TYPE	DATE	AMOUNT
17-01380-BR	RN	13 Nov 2017	Insp 15,000
05-3626	RN	16 Jan 2013	Comp 10,000

HISTORY	LAND	IMPR	TOTAL	
2017	6,500	10,200	16,700	Cama
2016	6,500	9,900	16,400	Cama
2015	6,500	9,900	16,400	Cama
2014	6,500	10,300	16,800	Cama
2013	6,500	11,300	17,800	Cama
2012	6,500	10,100	16,600	Cama
2011	6,500	8,400	14,900	Cama
2010	6,500	8,400	14,900	Cama
2009	11,500	7,000	18,500	Over
2008	10,000	10,500	20,500	Cama
2007	6,000	10,500	16,500	Cama
2006	8,000	20,000	28,000	Cama
2005	5,000	6,500	11,500	Cama
2004	4,000	7,500	11,500	Cama
2003	4,000	7,500	11,500	Cama
2002	5,000	6,000	11,000	Cama
2001	5,000	5,500	10,500	Cama
2000	5,000	5,500	10,500	Cama
1999	5,000	5,500	10,500	Cama
1998	1,500	5,500	7,000	Cama
1997	1,500	6,920	8,420	Over
1996	1,500	6,920	8,420	Over
1995	1,500	6,920	8,420	Over
1994	1,500	6,920	8,420	Over
1993	1,500	6,920	8,420	Over
1992	1,500	6,920	8,420	Over

COMMENTS:	
17 Oct 2017	TY17 COA PER OWNERS WRITTEN INSTR
09 Sep 2013	TAXPAYER 2014 -CHANGE OF ADDRESS PER USPS 5/23/13 - COV RETURNED TO SENDER
24 Oct 2012	COA PER P/O
14 Jan 2011	COA PER FORM FM OWNER
25 Jan 2006	ADD CHG PER FORM 1-25-06
02 Sep 2005	ADD CNG PER FORM 9/2/05 APW
02 Dec 2003	TY04 BAR/REDEMP 256Z214 8/19/3
17 Oct 2001	TY02 CC SH/D 220Q151 4-6-01
01 May 1998	OWNERS DECEASED HSE VACANT PER SON PHONE CALL



LAND														
ID#	USE DESC	FRONT	DEPTH	UNITS / TYPE	PRICE	ZONING	LCTN	TOPO	OTHER	ADJ1	ADJ2	ADJ3	ADJ4	MKT VALUE
44192	SINGLE FAMILY RES	30	97	1.00-LT	3000.00	R4								3000

2018 Chatham County Board of Assessors
Property Record Card

2-0019-17-034
218 CUMMING ST SAVANNAH

BUILDING SECTION	CONSTRUCTION TYPE	RCN	AYB	EYB	DEP TYPE	PHYS	ECON	FUNC	OBSV / %	TOTAL DEP %	RCNLD	U.FACTOR	MKT VAL
36815-1-2018	Residential	52,505	1955		MS	80.00	0.00	10.00	PD	90.00	5,251		6,300

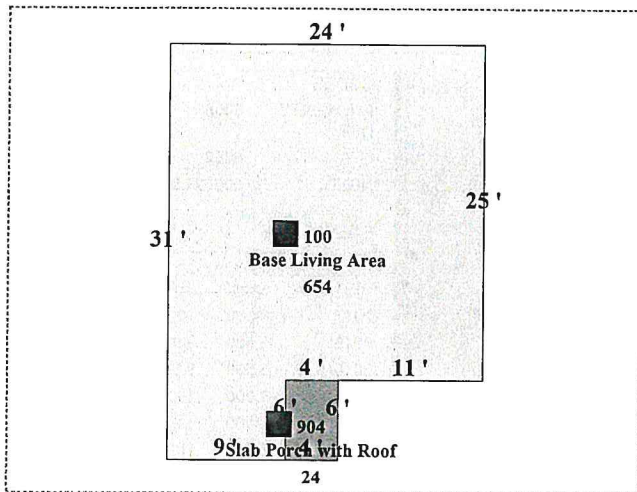

SECTION TYPE	1 - Main
AREA	654
TYPE	1 - Single-family Residence
FRAME	3 - Masonry Frame
STYLE	1 - One Story
QUALITY	2.00
CONDITION	3.00
# UNITS	0
# OF BEDS / BATHS	2 / 1.00

COMPONENTS	Units	%	QUAL
R1 163 Masonry, Concrete Block		100.00	
R2 208 Composition Shingle		100.00	
R4 402 Automatic Floor Cover Allowance			
R6 601 Plumbing Fixtures (#)	5.00		
R6 622 Raised Subfloor (% or SF)		100.00	
R11 904 Slab Porch (SF) with Roof	24.00		

[Click for larger picture]

BOARDED UP IN POOR CONDITION 3/28/2018